

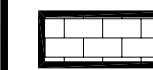

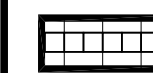



**LEGEND - FLOORING FINISHES**

**TILE**

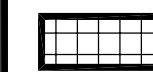
**DEMO:** 1. TILE CONTRACTOR IS RESPONSIBLE FOR THE DEMO OF ANY EXISTING TILE OR OLD CARPET WHERE NEW TILE IS INDICATED. 2. DEMO OF THE CARPET WHERE NEW CARPET IS INDICATED WILL BE REMOVED BY THE NEW CARPET CONTRACTOR (NOT IN THIS CONTRACT). 3. "FEATHER UP" SUB FLOOR ANYWHERE CARPET MEETS NEW TILE USING VINYL LEVELING MATERIAL INDICATED IN SPECIFICATION BOOKLET (NO REDUCER STRIPS BETWEEN THE 2 MATERIALS!).



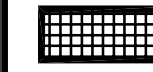

-  **TILE 1:** VS77 14X28 ONE COLOR SEE SPEC.
-  **TILE 2:** VS88 14X14 ONE COLOR SEE SPEC.
-  **TILE 3 - BASE:** VS77 7X14 TILE BASE, ONE COLOR SEE 02/1.01 & SPEC.
-  **TILE 4:** AV111/AV112 18X18 ONE COLOR SEE SPEC.
-  **TILE 5 - BASE:** 18X18 ONE COLOR (SAME AS TILE#4) CUT INTO 9X18 BASE WHERE TILE #4 IS SPEC.
-  **TILE 6 - WAINSCOTT:** VS77 7X14 TILE BASE, ONE COLOR, 3 TILES HIGH (42") SEE 02/1.01 FOR CAP DETAIL & SPEC.

**NOTE:** IN AREAS RECEIVING TILES #1 & #2 USE 7X14 TILE BASE (TILE 3), SEE SPEC.; IN AREAS RECEIVING TILE #4, USE TILE 5 FOR BASE, SEE SPEC.

-  **EXISTING TILE:** TO REMAIN, NOT INCLUDED IN THIS CONTRACT (N.I.C.).
-  **NO WORK**

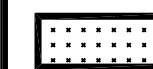
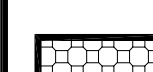
-  **TERRAZZO INSERTS** INCLUDED IN THIS CONTRACT
-  **TERRAZZO FLOORING** BY OTHERS

**CARPETS:**  
ALL NEW CARPETS BY OTHERS (SOME REMOVAL OF OLD, IN NEW TILE AREAS BY THE CONTRACTOR)

-  **CARPET 1:** WOVEN BROADLOOM; 6'-0" X 6'-0" REPEAT 12'-0" MATERIAL. (BY OTHERS)
-  **CARPET 2:** WOVEN BROADLOOM; NO REPEAT 12'-0" MATERIAL. ACCENT CARPET INLAYS TO BE PRE DRAWN IN THE FIELD AND APPROVED BY PIE INTERIOR DESIGNER. (BY OTHERS)
-  **CARPET 3:** TUFTED BROADLOOM; (BEHIND NOTED COUNTERS). (BY OTHERS)
-  **CARPET 4 WALK-OFF AREAS:** LEE'S "STEP-UP", 6'-0" WIDE ROLL MATERIAL, 5/32", 38OZ., # DD769, COLOR 508 BLACK (BY OTHERS)
-  **CARPET 5 WALK-OFF AREAS:** USING EXISTING PAWLING PRO-TEK ALUMINUM TREADS, REPLACE EXISTING BLUE CARPET INSERTS W/ PRO-TEK COLOR: BLACK; HEAVY DUTY CARPET STRIPS, REPAIR OR REPLACE ALUMINUM FRAMES AND/OR DAMAGED TREADS AS NEEDED (REPLACE ANY BENT OR DAMAGED TREAD OR FRAME)" (BY OTHERS)
-  **VINYL COMPOSITE TILE (VCT):** GENERAL CONTRACTOR TO PROVIDE VCT IN ITS ENTIRETY. AREAS RECEIVING VCT SHALL RECEIVE VINYL COVE BASE. (BY OTHERS)

EXISTING PRESSURE MATS @ GLASS DOOR ENTRIES TO REMAIN (TILE AROUND THEM).  
LOCATIONS OF THESE WILL BE REVIEWED DURING THE MANDATORY PRE-BID CONFERENCE.

**NOTE:** COORDINATE  
TILE CONTRACTOR IS RESPONSIBLE FOR COORDINATION OF A CONTINUOUS TILE & GROUT PATTERN AT LINE OF TRANSITION AT ALL DOORS TO PERIMETER WALK WAY.  
IE. CL 100, TB 100 ETC.

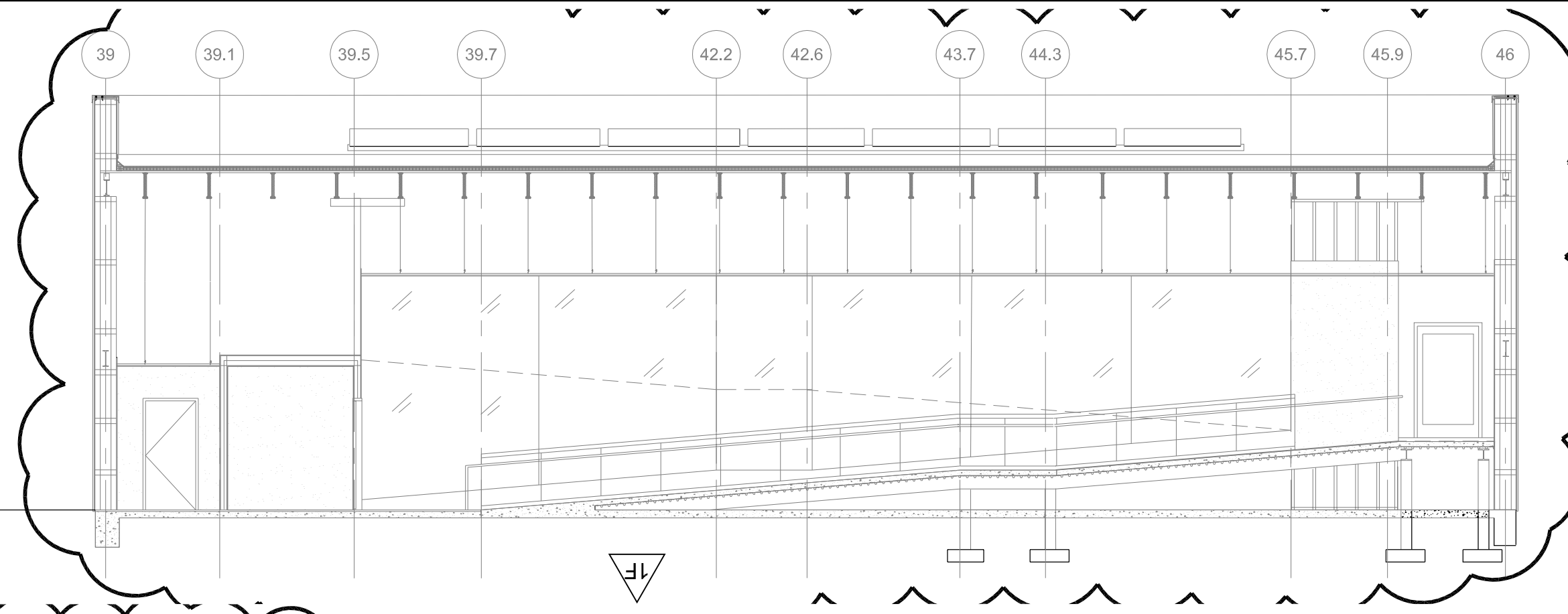

**2**  
A.1.02  
CROSSSECTION  
**GATES 2-6 RAMP**  
SCALE: 1/8" = 1'-0"

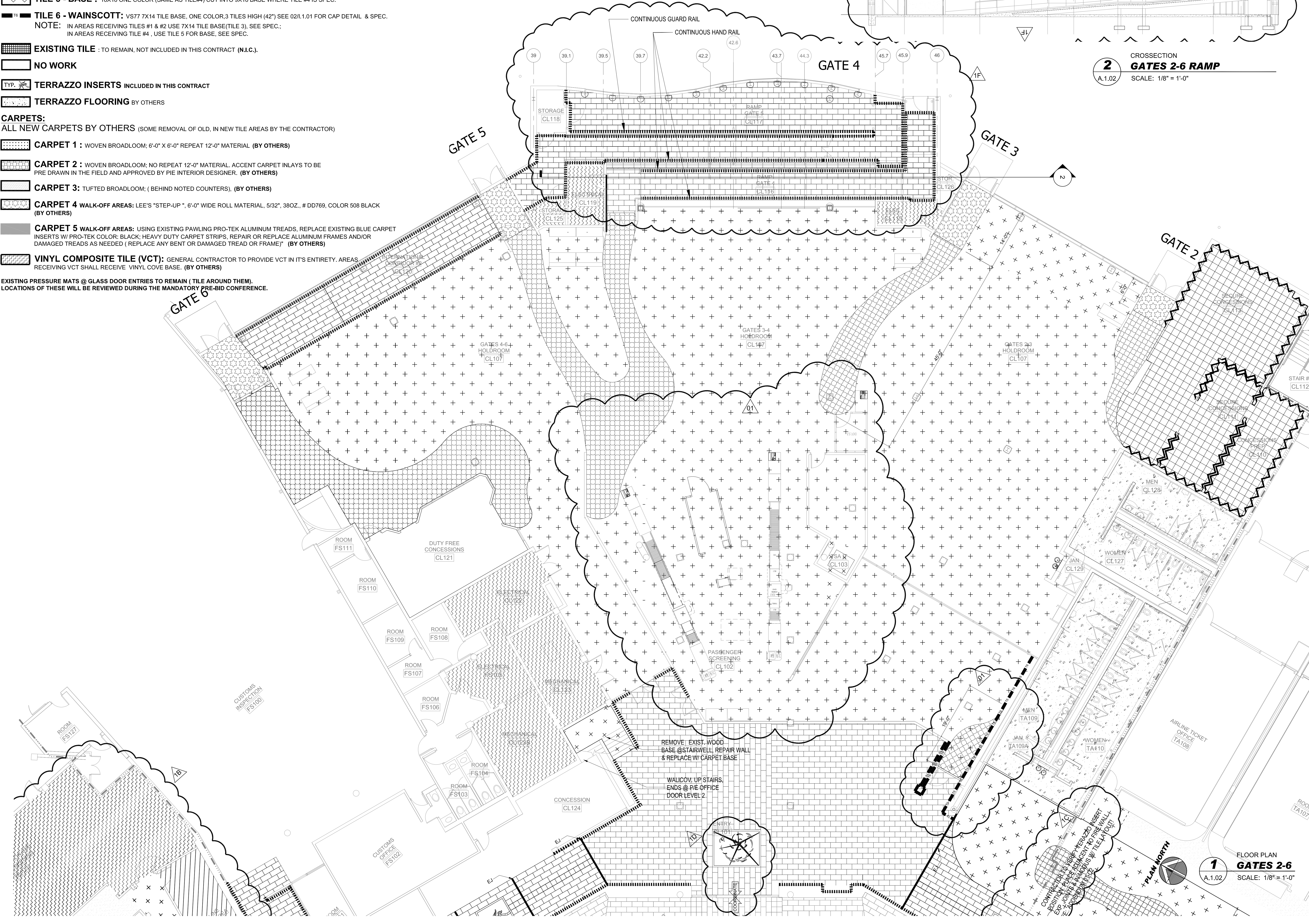

**THE LPA GROUP**  
ENGINEERS ARCHITECTS PLANNERS  
700 HUGER STREET  
COLUMBIA, SOUTH CAROLINA 29201  
POST OFFICE BOX 5803  
COLUMBIA, SOUTH CAROLINA 29250-5805  
Phone: 803/254-2211 Fax: 803/779-0482  
DENNIS J. WHEELER, FLORIDA ARCHITECT LICENSE # 11969  
LPA GROUP INCORPORATED, FLORIDA LICENSE # A0000054

**KTD Inc.**  
KELLY TAAFFE DESIGN  
Lic# ID: 0002289  
FL# 13 0001146  
Tel.: 813.685.5049  
Fax: 813.685.2571

**TERMINAL IMPROVEMENT PROJECT - TILE**

**KEY PLAN**

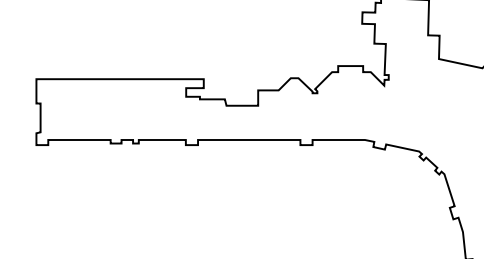

**REVISIONS**

No.	Description	Date	By
01	ADDENDUM #01 - RE BID		
	SEALD BID # 089-0289-CP(DM)	04/03/09	SB

Designed by: \_\_\_\_\_ Drawn by: \_\_\_\_\_ Checked by: \_\_\_\_\_  
Project Name: \_\_\_\_\_

**TERMINAL IMPROVEMENT PROJECT - TILE**

**FLOOR PLAN FINISHES**

LPA Project Number: **AR178005.8** FAA AIP Project Number: \_\_\_\_\_  
Date: **04.20.2009** Division: \_\_\_\_\_  
Drawing Number: \_\_\_\_\_

**I.1.02**

Plotted by: D:\6220\as on 4/19/2009 3:57:47 PM