

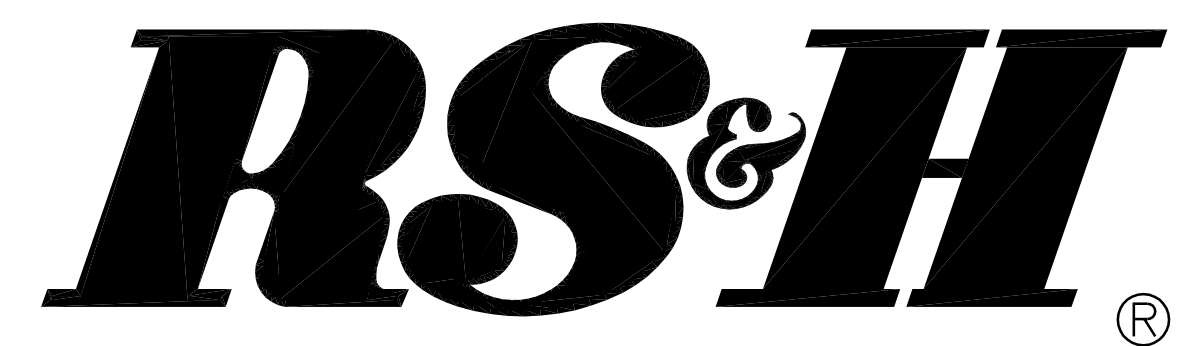

JAX

Jacksonville
International
Airport

JACKSONVILLE INTERNATIONAL AIRPORT BAGGAGE CLAIM



Reynolds, Smith and Hills, Inc.

Jacksonville, Florida 32256
904-256-2500 FAX 904-256-2501
FL.Cert.Nos. AAC001886 EB0005620 LCC000210

PROJECT

TERRAZZO FLOOR FINISHES
100% CD



Lic# ID 0002289
FL# 13 0001146
Kelly@kellytaaffedesign.com
Tel.: 813.695.5049
Fax: 813.805.2371

DRAWING INDEX

- AI.110 FLOOR PLAN IN CONTRACT WORK AREA 1/16" = 1'-0"
- AI.111 FLOOR PLAN PARTIAL IN CONTRACT AREA 3/32" = 1'-0"
- AI.112 FLOOR PLAN PARTIAL IN CONTRACT AREA 3/32" = 1'-0"
- AI.113 DETAILS DETAILS STAIRS VARIES
- AI.114 DETAILS DETAILS TZO FEATURES VARIES

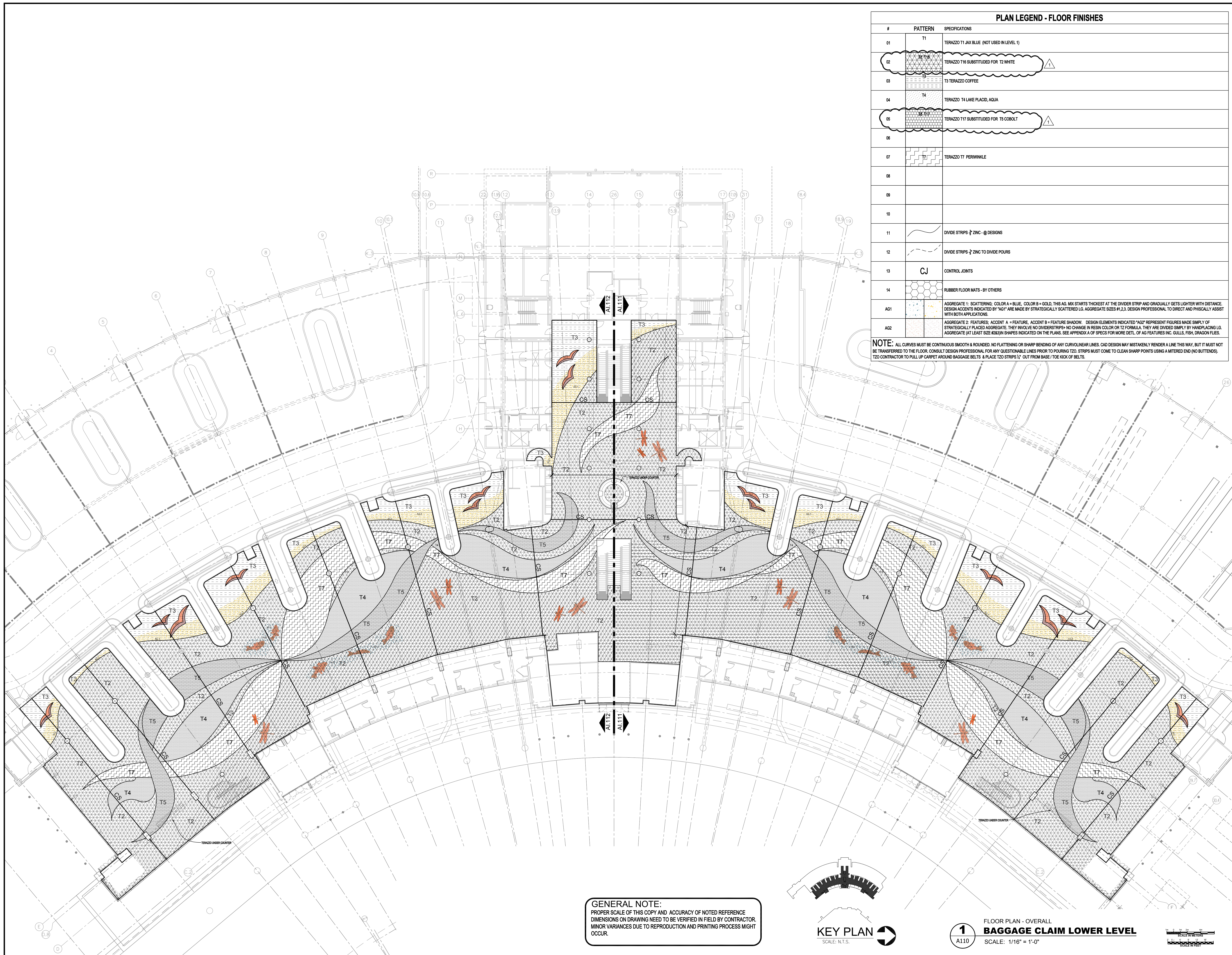

PLAN LEGEND - FLOOR FINISHES		
#	PATTERN	SPECIFICATIONS
01	T1	TERAZZO T1 JAX BLUE (NOT USED IN LEVEL 1)
02	T2	TERAZZO T16 SUBSTITUED FOR T2 WHITE
03	T3	TERAZZO COFFEE
04	T4	TERAZZO T4 LAKE PLACID, AQUA
05	T5	TERAZZO T17 SUBSTITUED FOR T5 CORBOLT
06		
07	T7	TERAZZO T7 PERIMWILE
08		
09		
10		
11		DIVIDE STRIPS 3/8" ZINC - @ DESIGNS
12		DIVIDE STRIPS 3/8" ZINC TO DIVIDE POURS
13	CJ	CONTROL JOINTS
14		RUBBER FLOOR MATS - BY OTHERS
AG1		AGGREGATE 1: SCATTERING; COLOR A = BLUE, COLOR B = GOLD, THIS AG. MIX STARTS THICKEST AT THE DIVIDER STRIP AND GRADUALLY GETS LIGHTER WITH DISTANCE. DESIGN ACCENTS INDICATED BY "AG1" ARE MADE BY STRATEGICALLY SCATTERING LG. AGGREGATE SIZES #1,2,3. DESIGN PROFESSIONAL TO DIRECT AND PHYSICALLY ASSIST WITH BOTH APPLICATIONS.
AG2		AGGREGATE 2: FEATURES; ACCENT A - FEATURE, ACCENT B - FEATURE SHADOW. DESIGN ELEMENTS INDICATED "AG2" REPRESENT FIGURES MADE SIMPLY OF STRATEGICALLY PLACED AGGREGATE. THEY INVOLVE NO DIVIDER STRIPS+ NO CHANGE IN RESIN COLOR OR T2 FORMULA. THEY ARE DIVIDED SIMPLY BY HANDPLACING LG. AGGREGATE (AT LEAST SIZE #2&3) IN SHAPES INDICATED ON THE PLANS. SEE APPENDIX A OF SPECS FOR MORE DETL. OF AG FEATURES INC. GULLS, FISH, DRAGON FLIES.

NOTE: ALL CURVES MUST BE CONTINUOUS SMOOTH & ROUNDED, NO FLATTENING OR SHARP BENDING OF ANY CURVILINEAR LINES. CAD DESIGN MAY MISTAKENLY RENDER A LINE THIS WAY, BUT IT MUST NOT BE TRANSFERRED TO THE FLOOR. CONSULT DESIGN PROFESSIONAL FOR ANY QUESTIONABLE LINES PRIOR TO POURING TZO. STRIPS MUST COME TO CLEAN SHARP POINTS USING A MITERED END (NO BUTTENDS). TZO CONTRACTOR TO PULL UP CARPET AROUND BAGGAGE BELTS & PLACE TZO STRIPS 1/2" OUT FROM BASE / TOE KICK OF BELTS.

GENERAL NOTE:
 PROPER SCALE OF THIS COPY AND ACCURACY OF NOTED REFERENCE DIMENSIONS ON DRAWING NEED TO BE VERIFIED IN FIELD BY CONTRACTOR. MINOR VARIANCES DUE TO REPRODUCTION AND PRINTING PROCESS MIGHT OCCUR.

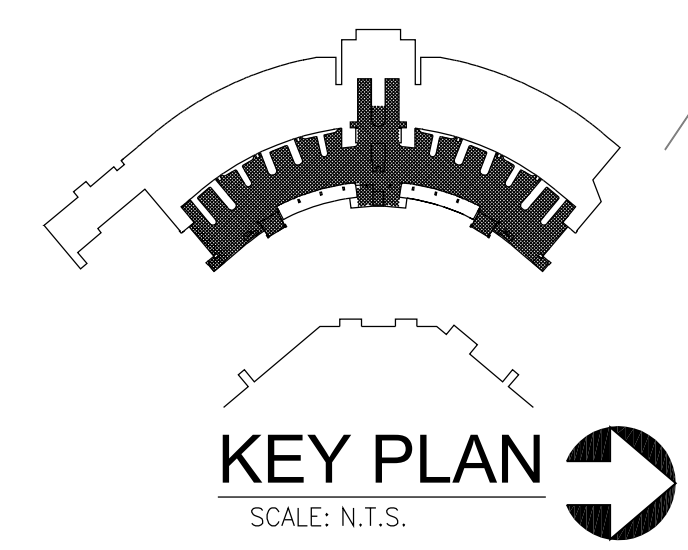

1
 A110
 FLOOR PLAN - OVERALL
BAGGAGE CLAIM LOWER LEVEL
 SCALE: 1/16" = 1'-0"

RS&H
 Architectural, Engineering, Planning
 and Environmental Services
 Reynolds, Smith and Hills, Inc.
 1748 Chestwood Park, Boulevard South
 Jacksonville, Florida 32256
 904-256-2500 FAX 904-256-2501
 www.rsandh.com
 FL Cert Nos. AAC001886 EB0005620 LOC000210

JAX
 Jacksonville
 International
 Airport
JACKSONVILLE
 AVIATION AUTHORITY

JACKSONVILLE
INTERNATIONAL
AIRPORT

INTERIOR DESIGN
FLOOR FINISHES

KTD Inc.
Design
 KELLY TAAFFE DESIGN

Lic# ID 0002289
 FL# 13 0001146
 Kelly@kellytaaffedesign.com
 Tel: 813.895.5049
 Fax: 813.895.2371

REVISIONS		
NO.	DESCRIPTION	DATE
1	TZO LEGEND	11/02/11

DATE ISSUED: 9.25.2011
 REVIEWED BY: KT
 DRAWN BY: cAdvice.us - SB
 DESIGNED BY: KTD.INC - KT
 AEP PROJECT NUMBER
 201-7262-009
 © 2006 REYNOLDS, SMITH AND HILLS, INC.
 SHEET TITLE

LEVEL I
BAGGAGE CLAIM
TERAZZO

SHEET NUMBER
A110

LEVEL-1-CD100.DWG

PLAN LEGEND - FLOOR FINISHES

#	PATTERN	SPECIFICATIONS
01	T1	TERAZZO T1 JAY BLUE (NOT USED IN LEVEL 1)
02	T2	TERAZZO T16 SUBSTITUED FOR T2 WHITE
03	T3	T3 TERAZZO COFFEE
04	T4	TERAZZO T4 LAKE PLACID, AQUA
05	T5	TERAZZO T17 SUBSTITUED FOR T5 COBALT
06		
07	T7	TERAZZO T7 PERWINKLE
08		
09		
10		
11		DIVIDE STRIPS - ZINC - @ DESIGNS
12		DIVIDE STRIPS - ZINC TO DIVIDE POURS
13	CJ	CONTROL JOINTS
14		RUBBER FLOOR MATS - BY OTHERS
AG1		AGGREGATE 1: SCATTERING; COLOR A = BLUE, COLOR B = GOLD, THIS AG. MIX STARTS THICKEST AT THE DIVIDER STRIP AND GRADUALLY GETS LIGHTER WITH DISTANCE. DESIGN ACCENTS INDICATED BY "AG1" ARE MADE BY STRATEGICALLY SCATTERED LG. AGGREGATE SIZES #1, 2, 3. DESIGN PROFESSIONAL TO DIRECT AND PHYSICALLY ASSIST WITH BOTH APPLICATIONS.
AG2		AGGREGATE 2: FEATURES; ACCENT A = FEATURE, ACCENT B = FEATURE SHADOW. DESIGN ELEMENTS INDICATED "AG2" REPRESENT FIGURES MADE SIMPLY OF STRATEGICALLY PLACED AGGREGATE. THEY INVOLVE NO DIVIDERSTRIPS NO CHANGE IN RESIN COLOR OR T2 FORMULA. THEY ARE DIVIDED SIMPLY BY HANDPLACING LG. AGGREGATE (AT LEAST SIZE #2&3) IN SHAPES INDICATED ON THE PLANS. SEE APPENDIX A OF SPECS FOR MORE DETL. OF AG FEATURES INC. GULLS, FISH, DRAGON FLIES.

NOTE: ALL CURVES MUST BE CONTINUOUS SMOOTH & ROUNDED. NO FLATTENING OR SHARP BENDING OF ANY CURVILINEAR LINES. CAD DESIGN MAY MISTAKENLY RENDER A LINE THIS WAY, BUT IT MUST NOT BE TRANSFERRED TO THE FLOOR. CONSULT DESIGN PROFESSIONAL FOR ANY QUESTIONABLE LINES PRIOR TO POURING TZO. STRIPS MUST COME TO CLEAN SHARP POINTS USING A MITERED END (NO BUTTENDS). TZO CONTRACTOR TO PULL UP CARPET AROUND BAGGAGE BELTS & PLACE TZO STRIPS 1/2" OUT FROM BASE / TOE KICK OF BELTS.

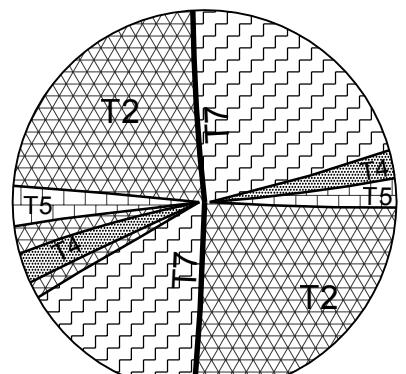

TZO DETAIL NOTE:
 3/8" STRIP FRAMING T7 TO CONTINUE THROUGH INTERSECTION OF ALL CONJOINING STRIPS. WHENEVER ONE LINE APPEARS TO CROSS OVER TOP OF OTHER LINES IT (STRIPS) MUST BE CONTINUOUS THROUGH THE INTERSECTION.

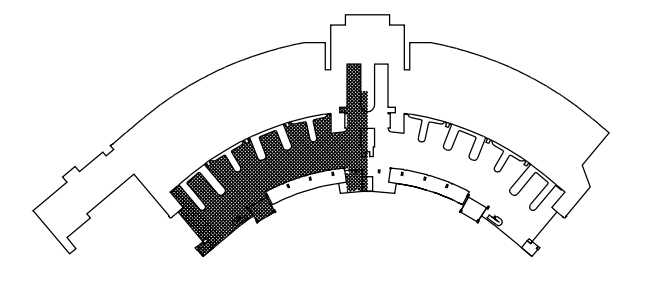

KEY PLAN
 SCALE: N.T.S.

1
 AI.1.1.2

FLOOR PLAN - PARTIAL WEST
BAGGAGE CLAIM SOUTH WING
 SCALE: 3/32" = 1'-0"

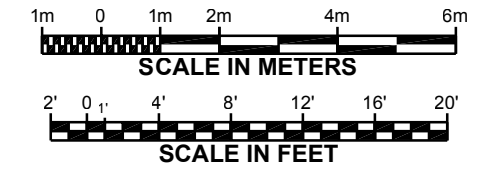

GENERAL NOTE:
 PROPER SCALE OF THIS COPY AND ACCURACY OF NOTED REFERENCE DIMENSIONS ON DRAWING NEED TO BE VERIFIED IN FIELD BY CONTRACTOR. MINOR VARIANCES DUE TO REPRODUCTION AND PRINTING PROCESS MIGHT OCCUR.

RS&H
 Architectural, Engineering, Planning and Environmental Services
 Reynolds, Smith and Hills, Inc.
 10748 Deerwood Park Boulevard South
 Jacksonville, Florida 32256
 904-256-2500 FAX 904-256-2501
 www.rsandh.com
 FL Cert. Nos. AAC001886 EB0005820 LGC000210

JAX
 Jacksonville International Airport
JACKSONVILLE
 AVIATION AUTHORITY

JACKSONVILLE INTERNATIONAL AIRPORT

INTERIOR DESIGN FLOOR FINISHES

KTD Inc.
Design
 KELLY TAAFFE DESIGN

Lic# ID 0002289
 FL# 13 0001146
 Kelly@kellytaaffedesign.com
 Tel: 813.855.5049
 Fax: 813.805.2371

REVISIONS

NO.	DESCRIPTION	DATE
1	TZO LEGEND	11/02/11

DATE ISSUED: 9.25.2011
 REVIEWED BY: KT
 DRAWN BY: cAdvice.us - SB
 DESIGNED BY: KTD.INC - KT
 AEP PROJECT NUMBER
 201-7262-009
 © 2006 REYNOLDS, SMITH AND HILLS INC.

SOUTH WING LEVEL I BAGGAGE CLAIM TERAZZO

SHEET NUMBER

AI.112
 LEVEL-1-CD100.DWG

BID ALTERNATE

GENERAL NOTE:
 PROPER SCALE OF THIS COPY AND ACCURACY OF NOTED REFERENCE DIMENSIONS ON DRAWING NEED TO BE VERIFIED IN FIELD BY CONTRACTOR. MINOR VARIANCES DUE TO REPRODUCTION AND PRINTING PROCESS MIGHT OCCUR.

NOTE:
 ALL CURVILINEAR DESIGN ELEMENTS TO HAVE SMOOTH TRANSITIONS BETWEEN CURVES TO BE REFLECTED IN 7'-11" SHOP DRAWINGS AND ON SITE LAYOUT.
 CONTRACTOR REQUIRED TO INTERFACE W/ ALL NEW OR EXISTING WALL BASE MATERIALS (MAJORITY WALL BASE = STAINLESS STEEL) WALL BASE BY OTHERS.
 CONTROL + EXPANSION JOINTS TO ADHERE TO ALL NTMA SPECIFICATIONS FOR EXISTING SLAB. CONTRACTOR TO REFLECT TYPICAL PLACEMENT AND TYPE IN SHOP DRAWINGS SUBMITTAL.
 WALL BASE BY OTHERS UNLESS OTHERWISE NOTED (EX. STRINGERS AT STAIRS INCLUDED IN SOME CASES, SEE DETAILS).
 AGGREGATE FOR SCATTERING AND FEATURES DOES NOT IN ANYWAY INCREASE THE OVERALL AMOUNT OF AGGREGATE NEEDED FOR THE PROJECT. THE CONTRACTOR SHALL CALCULATE BY SUBSTITUTING AGGREGATES FOR SCATTERING AND FEATURES FOR REGULAR MATRIX AGGREGATES.

PLAN LEGEND - FLOOR FINISHES		
#	PATTERN	SPECIFICATIONS
01	T1	TERAZZO T1 JAX BLUE (NOT USED IN LEVEL 1)
02	T2	TERAZZO T2 SUBSTITUED FOR T2 WHITE
03	T3	T3 TERAZZO COFFEE
04	T4	TERAZZO T4 LAKE PLACID, AQUA
05	T5	TERAZZO T5 SUBSTITUED FOR T5 COBALT
06		
07	T7	TERAZZO T7 PERIWINKLE
08		
09		
10		
11		DIVIDE STRIPS - ZINC - @ DESIGNS
12		DIVIDE STRIPS - ZINC TO DIVIDE POURS
13	CJ	CONTROL JOINTS
14		RUBBER FLOOR MATS - BY OTHERS
AG1		AGGREGATE 1: SCATTERING; COLOR A = BLUE, COLOR B = GOLD. THIS AG MIX STARTS THICKEST AT THE DIVIDER STRIP AND GRADUALLY GETS LIGHTER WITH DISTANCE. DESIGN ACCENTS INDICATED BY "AG1" ARE MADE BY STRATEGICALLY SCATTERED LG. AGGREGATE SIZES #1,2,3. DESIGN PROFESSIONAL TO DIRECT AND PHYSICALLY ASSIST WITH BOTH APPLICATIONS.
AG2		AGGREGATE 2: FEATURES; ACCENT A = FEATURE, ACCENT B = FEATURE SHADOW. DESIGN ELEMENTS INDICATED "AG2" REPRESENT FIGURES MADE SIMPLY OF STRATEGICALLY PLACED AGGREGATE. THEY INVOLVE NO DIVIDER STRIPS + NO CHANGE IN RESIN COLOR OR TZ FORMULA. THEY ARE DIVIDED SIMPLY BY HANDPLACING LG. AGGREGATE AT LEAST SIZE #6,8,10,12 SHAPES INDICATED ON THE PLANS. SEE APPENDIX A OF SPECS FOR MORE DETL. OF AG FEATURES INC. GULLS, FISH, DRAGON FLIES.

NOTE: ALL CURVES MUST BE CONTINUOUS SMOOTH & ROUNDED. NO FLATTENING OR SHARP BENDING OF ANY CURVILINEAR LINES. CAD DESIGN MAY MISTAKENLY RENDER A LINE THIS WAY, BUT IT MUST NOT BE TRANSFERRED TO THE FLOOR. CONSULT DESIGN PROFESSIONAL FOR ANY QUESTIONABLE LINES PRIOR TO POURING TZO. STRIPS MUST COME TO CLEAN SHARP POINTS USING A MITERED END (NO BUTTENDS). TZO CONTRACTOR TO PULL UP CARPET AROUND BAGGAGE BELTS & PLACE TZO STRIPS 1/2" OUT FROM BASE / TOE KICK OF BELTS.

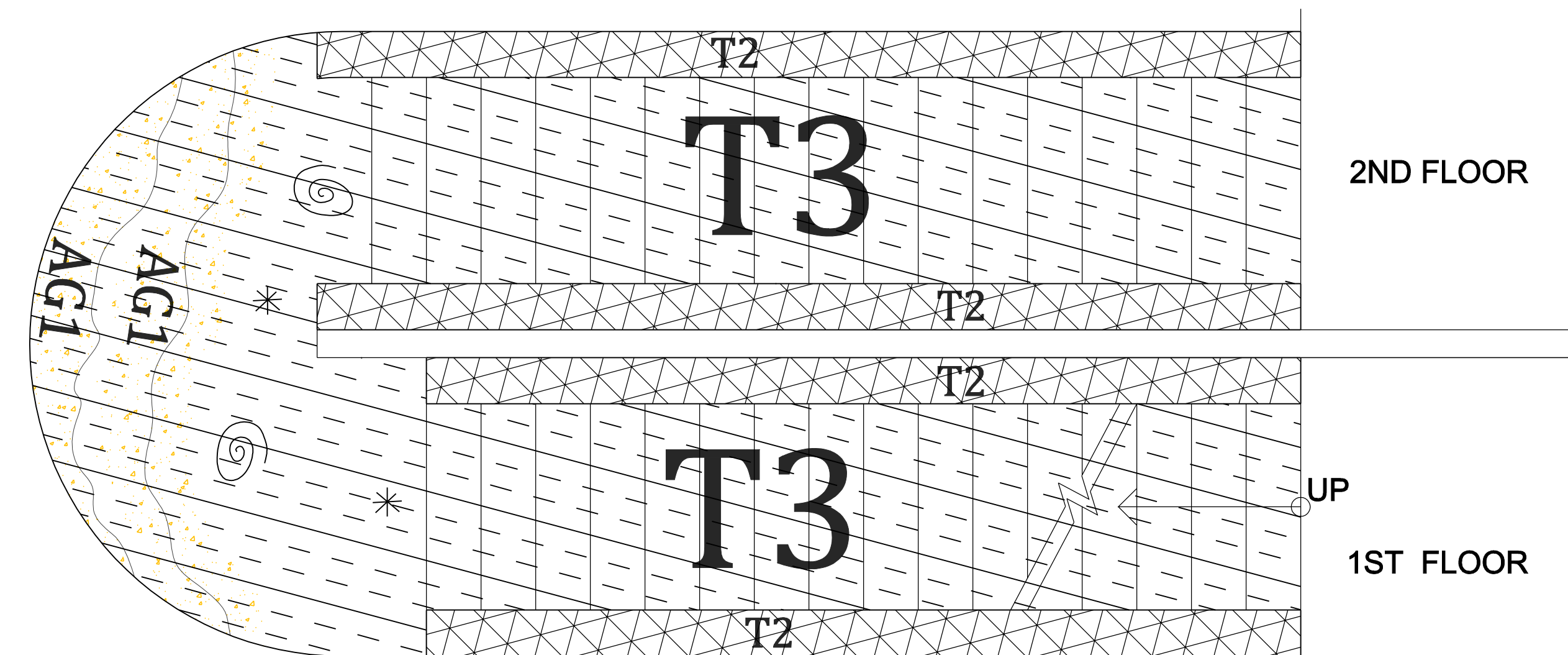

2 FLOOR PLAN - STAIRS
BAGGAGE CLAIM SOUTH STAIR
 SCALE: 1/2" = 1'-0"

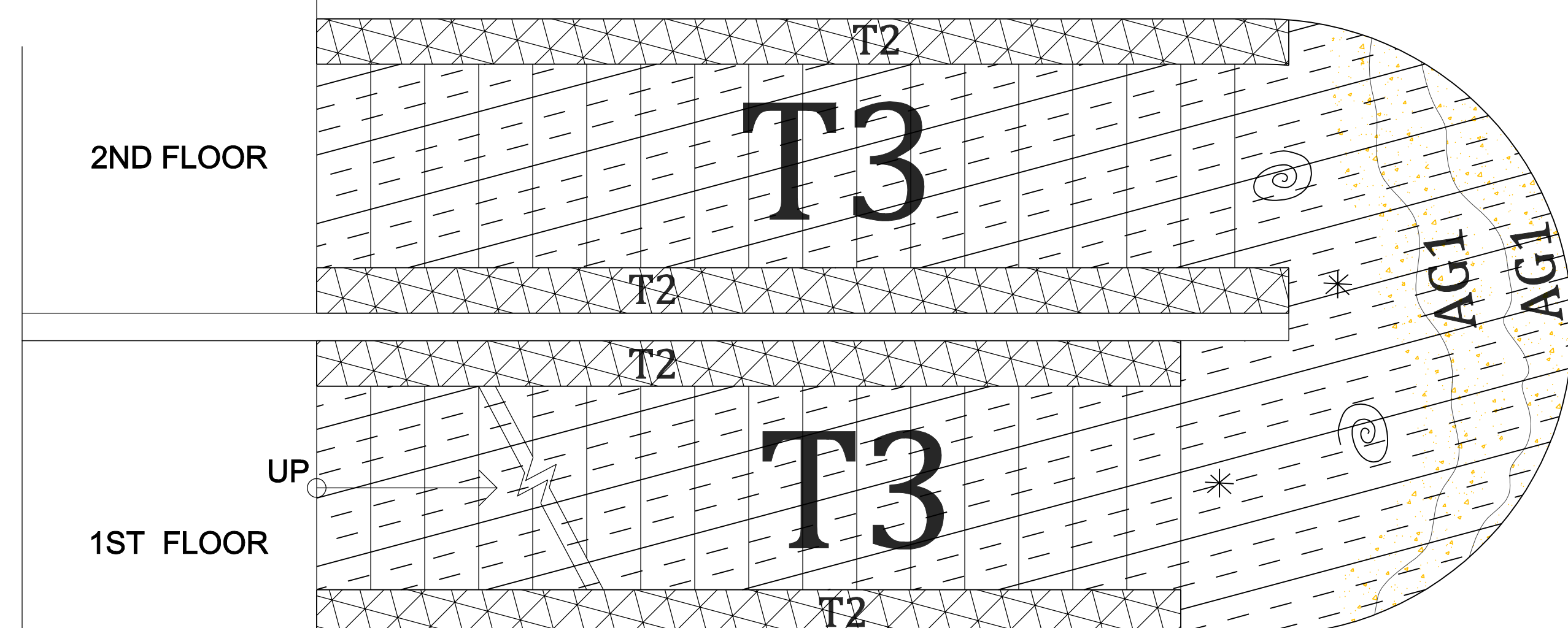

1 FLOOR PLAN - STAIRS
BAGGAGE CLAIM NORTH STAIR
 SCALE: 1/2" = 1'-0"

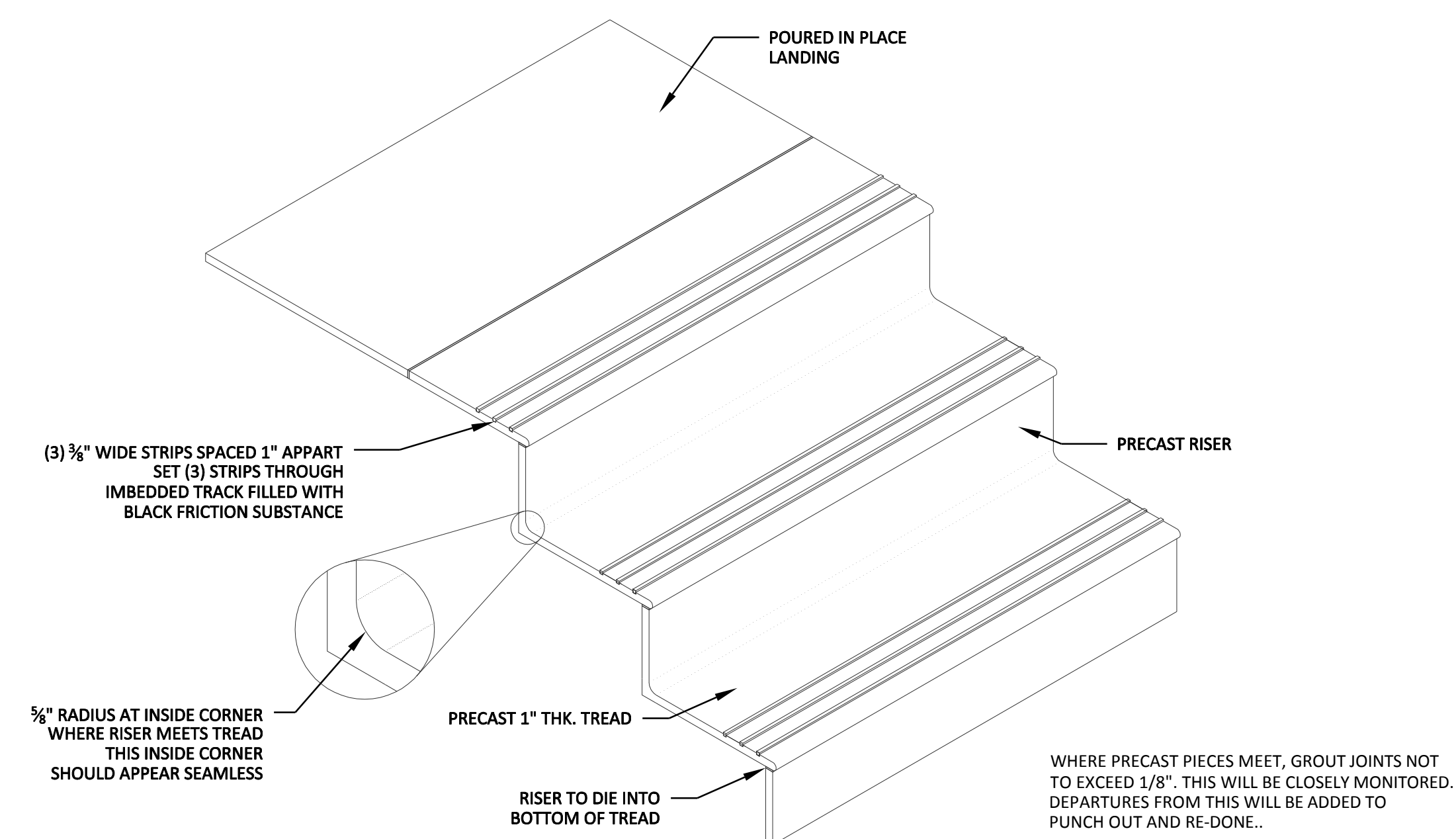

3 STAIR DETAIL
 SCALE: 1/2" = 1'-0"
 "FINISHED STAIR SYSTEMS MUST COMPLY WITH ALL ADA AND SAFETY CODES."

RS&H
 Architectural, Engineering, Planning
 and Environmental Services
 Reynolds, Smith and Hills, Inc.
 1748 Chestwood Park, Balairend South
 Jacksonville, Florida 32256
 904-256-2500 FAX 904-256-2501
 www.rsandh.com
 FL Cert Nos. AAC001886 EB0005620 LOC000210

JAX
 Jacksonville
 International
 Airport
JACKSONVILLE
 AVIATION AUTHORITY

JACKSONVILLE
INTERNATIONAL
AIRPORT

INTERIOR DESIGN
FLOOR FINISHES

KTD Inc.
Design
 KELLY TAAFFE DESIGN

Lic# ID 0002289
 FL# 13 0001146
 Kelly@kellytaaffedesign.com
 Tel.: 813.895.5049
 Fax: 813.895.2371

REVISIONS		
NO.	DESCRIPTION	DATE
1	TZO LEGEND	11/02/11

DATE ISSUED: 9.25.2011
 REVIEWED BY: KT
 DRAWN BY: cAdvice.us - SB
 DESIGNED BY: KTD, INC - KT
 AEP PROJECT NUMBER
 201-7262-009
 © 2006 REYNOLDS, SMITH AND HILLS, INC.

SHEET TITLE
STAIRS
LEVEL I
BID ALTERNATE
TERAZZO

SHEET NUMBER
AI.113
 LEVEL-1-CD100.DWG

GENERAL NOTE:
 PROPER SCALE OF THIS COPY AND ACCURACY OF NOTED REFERENCE DIMENSIONS ON DRAWING NEED TO BE VERIFIED IN FIELD BY CONTRACTOR. MINOR VARIANCES DUE TO REPRODUCTION AND PRINTING PROCESS MIGHT OCCUR.

REVISIONS

NO.	DESCRIPTION	DATE
1	TZO LEGEND	11/02/11

DATE ISSUED: 9.25.2011
 REVIEWED BY: KT
 DRAWN BY: cAdvice.us - SB
 DESIGNED BY: KTD.INC - KT
 AEP PROJECT NUMBER
 201-7262-009
 © 2006 REYNOLDS, SMITH AND HILLS, INC.

SHEET TITLE
DETAILS
LEVEL I
BAGAGE CLAIM
TERAZZO
 SHEET NUMBER
AI.114
 LEVEL-1-CD100.DWG

EPOXY TERRAZZO 1/4" OR 3/8"

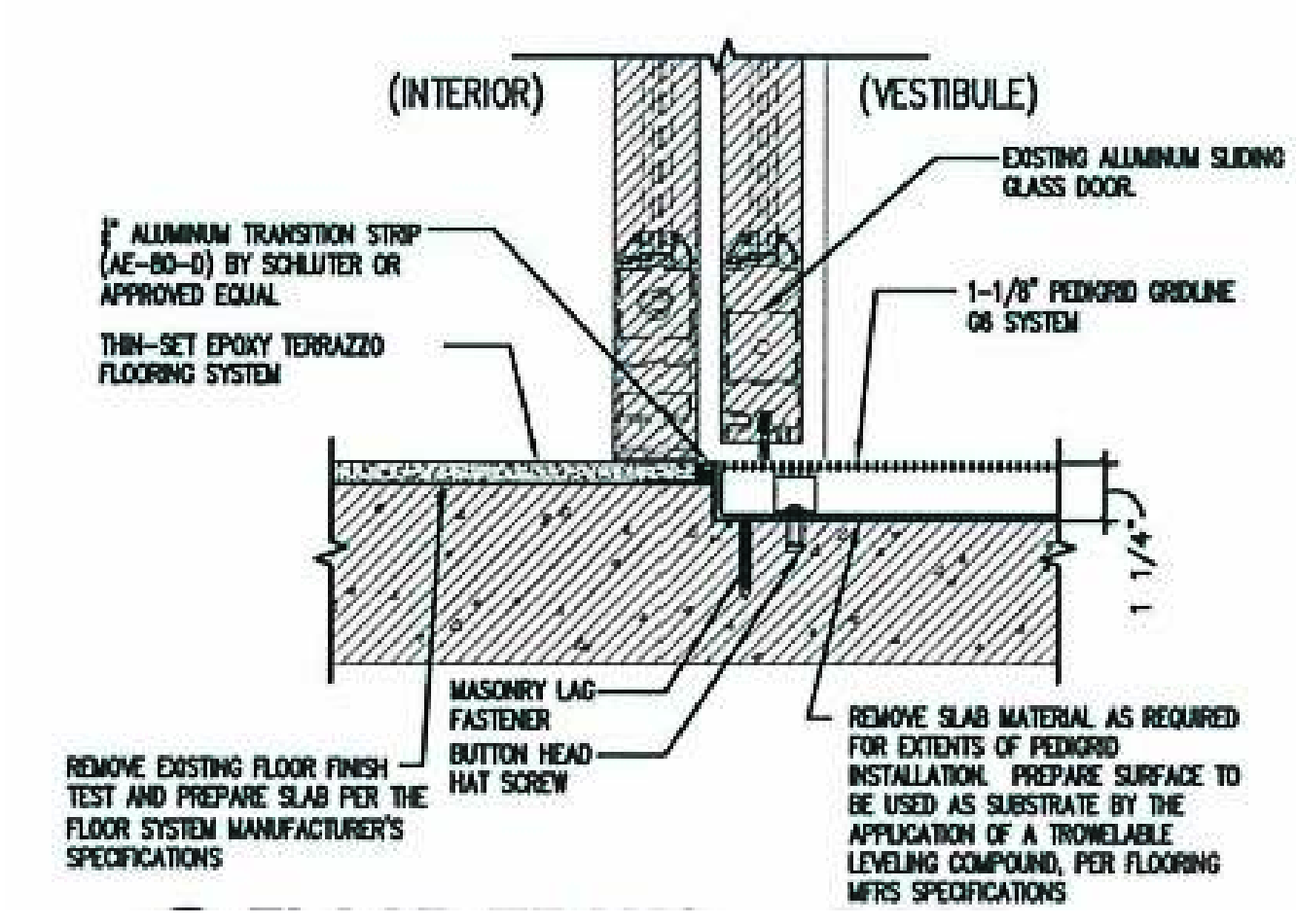

1 FLOOR TRANSITION @ DOOR
 AI.114 SCALE: N/A

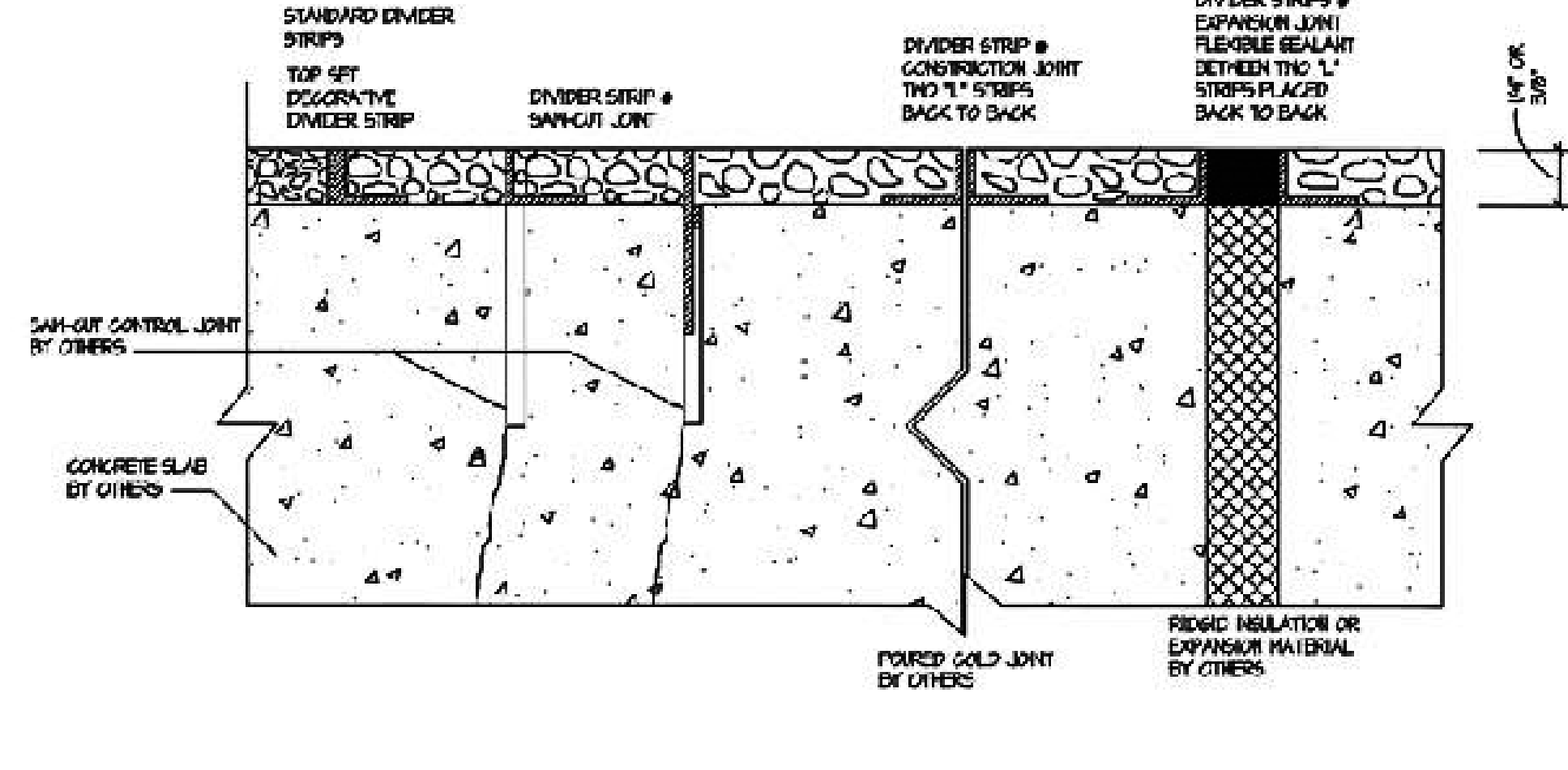

2 STANDARD DIVIDER STRIPS
 AI.114 SCALE: N/A

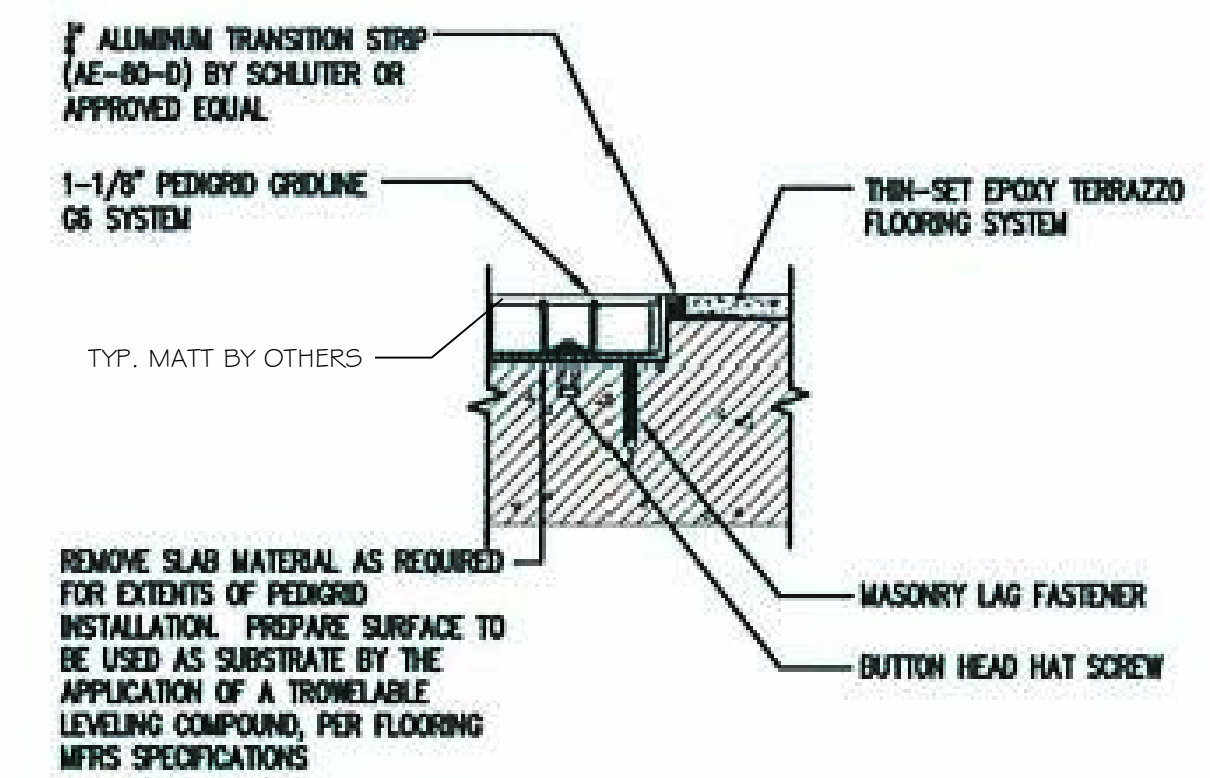

3 W.O.MATT/TERR TRANSITION
 AI.114 SCALE: N/A

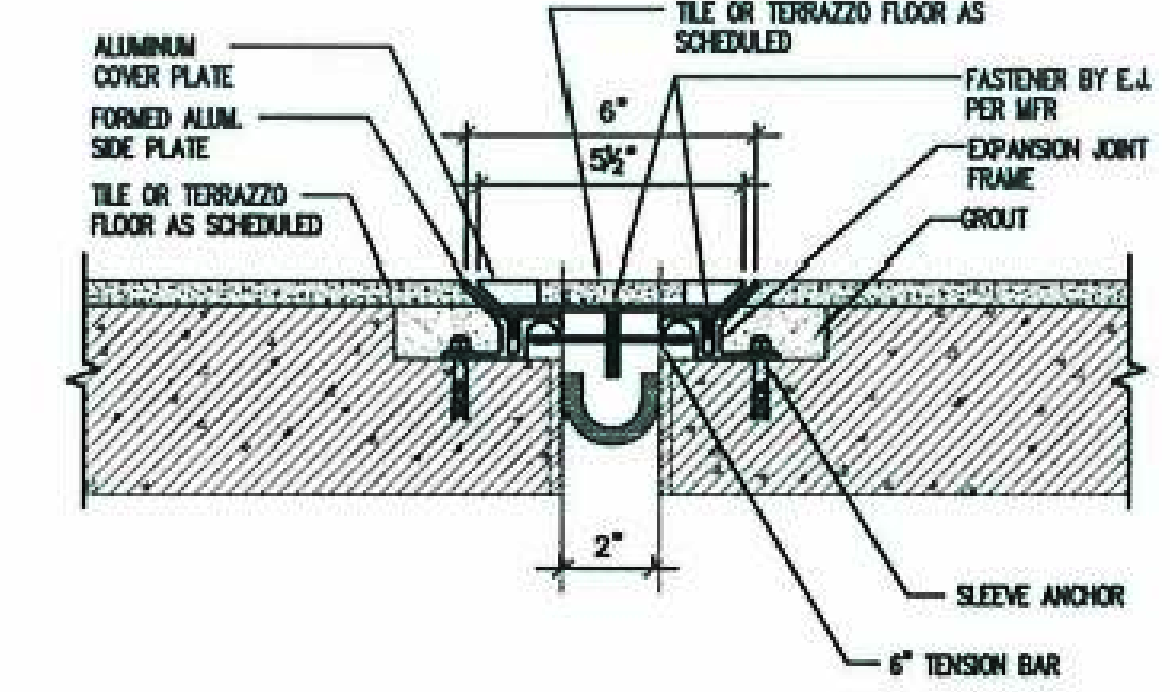

4 EXPANSION JOINT DTL.
 AI.114 SCALE: N/A

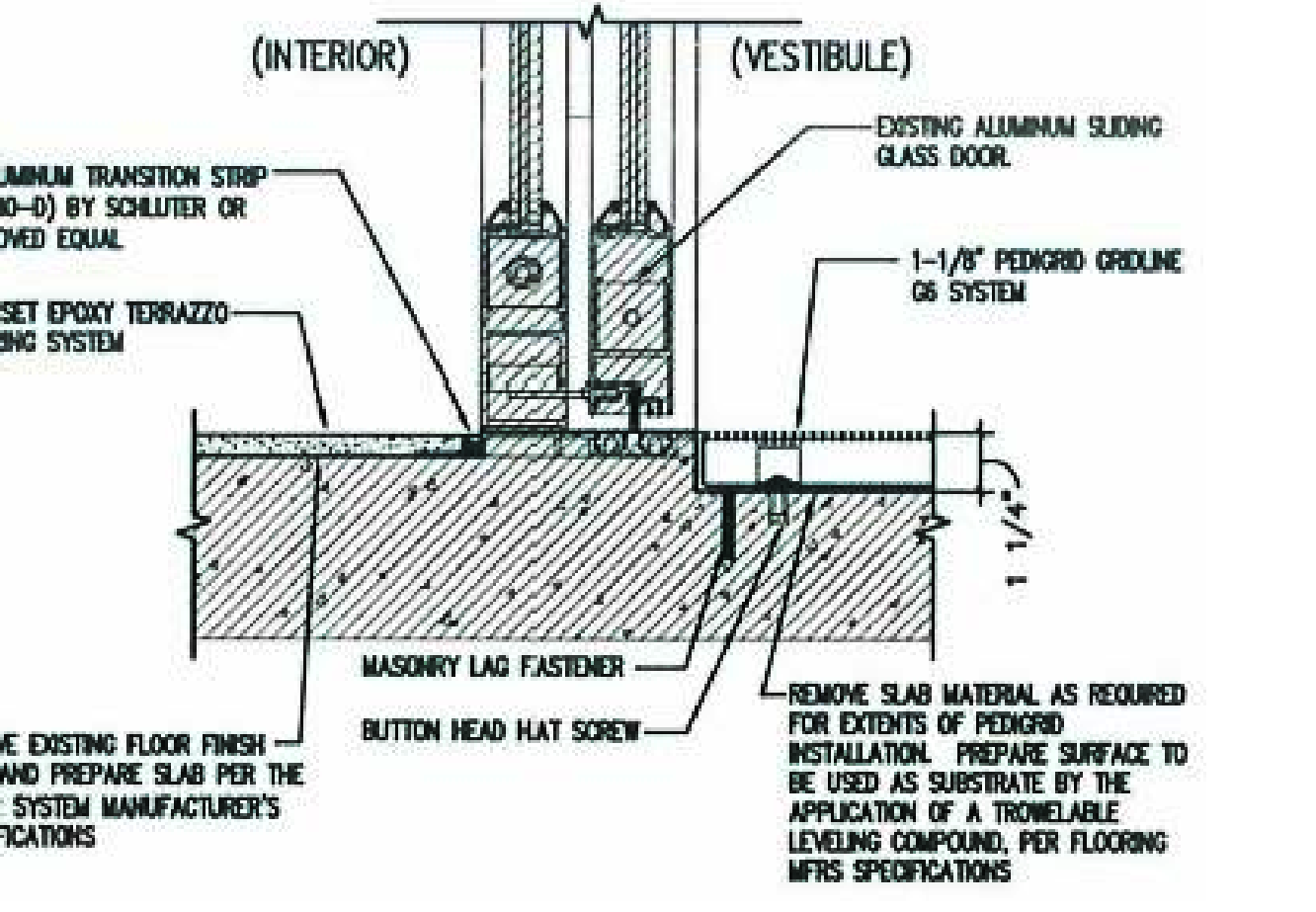

5 INTERIOR DOOR THRESHOLD
 AI.114 SCALE: N/A

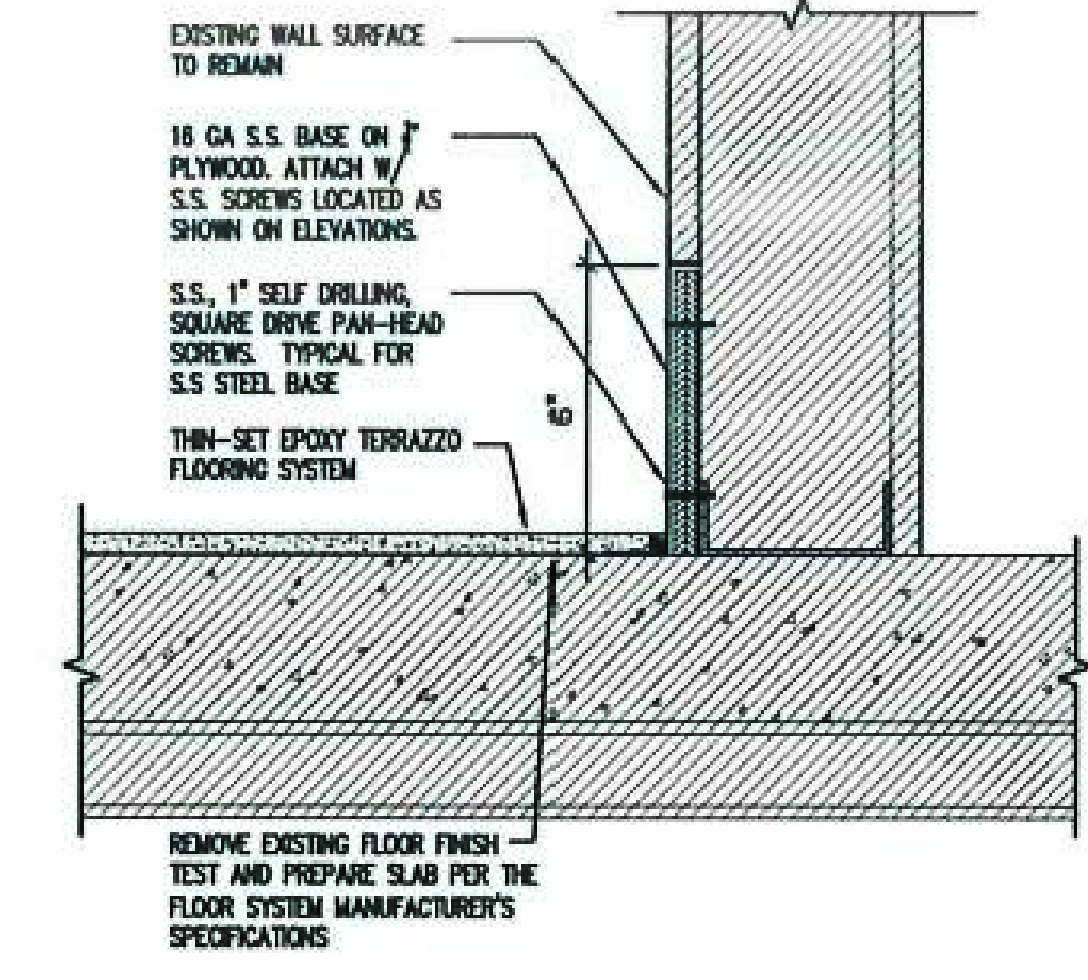

6 STAINLESS STEEL BASE DTL.
 AI.114 SCALE: N/A

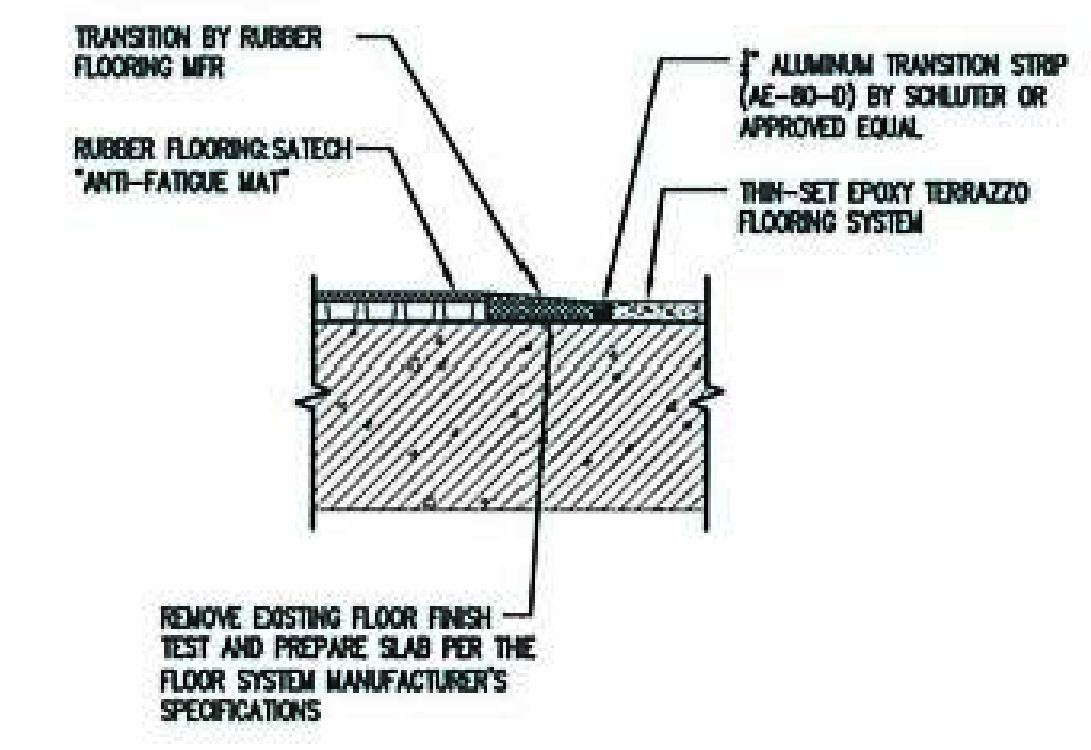

7 TERR / RUBBER FLOOR TRANS
 AI.114 SCALE: N/A

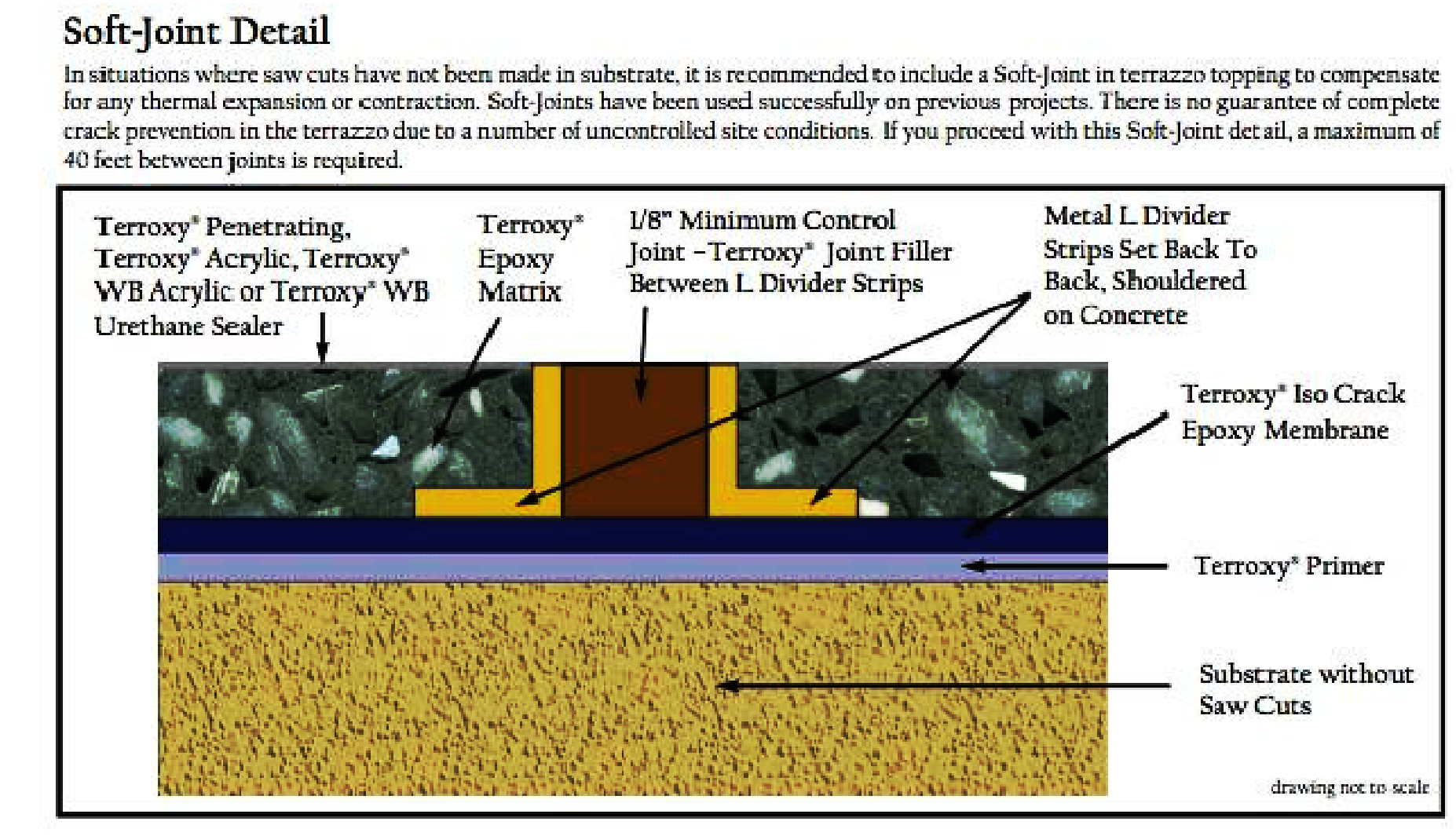

08 SOFT JOINT DETAIL
 AI.114 SCALE: N/A



09 AI.114
 EXAMPLES OF AGGREGATE DESIGN FEATURES-DESIGN FEATURES ACHIEVED BY LAYING LARGER AGGREGATE INTO SPECIFIC SHAPES AND IMAGES.



10 AI.114
 EXAMPLE OF AGG SCATTERING-RANDOM VARIATIONS TO AGGREGATE ACHIEVED BY SCATTERING LARGER AGG. AMONG REGULAR MATRIX JUST AFTER IT IS POURED, WHILE IT IS IN LIQUID STATE

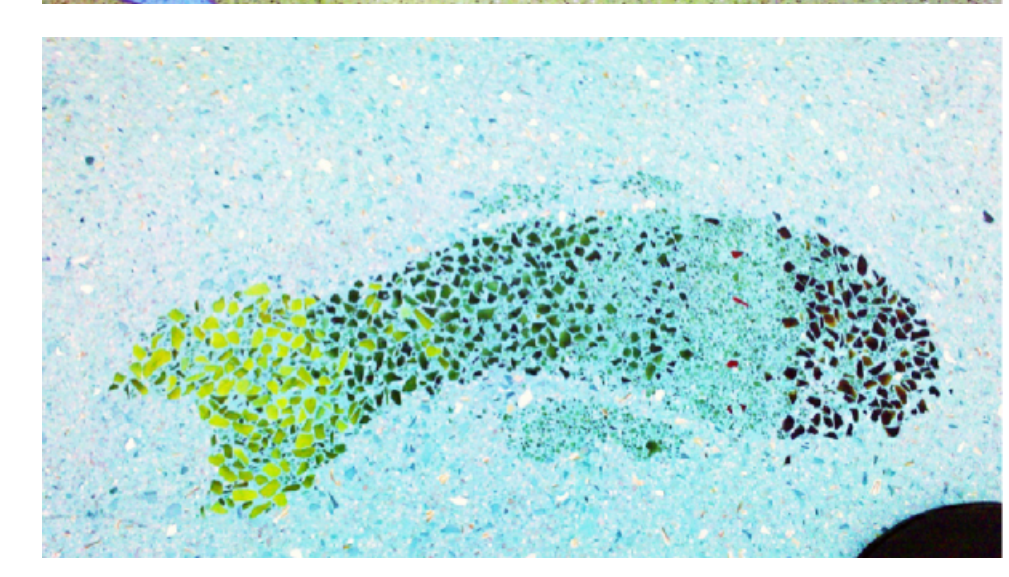

11 AI.114
AG-2 DESIGN FEATURES
 SCALE: N/A

