

#	PATTERN	SPECIFICATIONS
01	T1	TERRAZZO T1 JAX BLUE (NOT USED IN LEVEL 1)
02	T2	TERRAZZO T16 SUBSTITUED FOR T2 WHITE
03	T3	TERRAZZO T3 COFFEE
04	T4	TERRAZZO T4 LAKE PLACID, AQUA
05	T5	TERRAZZO T17 SUBSTITUED FOR T5 COBOLT
06		
07	T7	TERRAZZO T7 PERIMWILE
18		TERRAZZO T18 GULL BODIES RESIN: TERROXY STD. WHITE 50% RUST-FREE METAL SHAVINGS 20% BLANCO MEXICANO # 1&2 20% MIRROR # 1 & 2 10% FW MOP #3
19		TERRAZZO T19 GULL SHADOWS RESIN: TERROXY # 788-40 INDIGO VELVET 20% DARK BLUE GLASS # FINE & 1 20% DARK GRAY GLASS # FINE & 1 50% RECYCLED PLATE GLASS # 0.1
10		
11		DIVIDE STRIPS 3/4" ZINC - @ DESIGNS
12		DIVIDE STRIPS 3/4" ZINC TO DIVIDE POURS
13	CJ	CONTROL JOINTS
14		RUBBER FLOOR MATS - BY OTHERS
AG1		AGGREGATE 1: SCATTERING; COLOR A = BLUE, COLOR B = GOLD, THIS AG. MIX STARTS THICKEST AT THE DIVIDER STRIP AND GRADUALLY GETS LIGHTER WITH DISTANCE. DESIGN ACCENTS INDICATED BY "AG1" ARE MADE BY STRATEGICALLY SCATTERED LG. AGGREGATE SIZES #1,2,3. DESIGN PROFESSIONAL TO DIRECT AND PHYSICALLY ASSIST WITH BOTH APPLICATIONS.
AG2	A02	AGGREGATE 2: FEATURES; AGENT-A - FEATURE; AGENT-B - FEATURE; SHADOWS - DESIGN ELEMENTS INDICATED "AG2" REPRESENT FIGURES MADE SIMPLY OF STRATEGICALLY PLACED AGGREGATE. THEY WILL NOT BE DIVIDED BY STRIPS. NO CHANGE IN RESIN COLOR OR T2 FORMULA. THEY ARE DIVIDED SIMPLY BY HANDPLACING LG. AGGREGATE AT LEAST SIZE #2&3 IN SHAPES INDICATED ON THE PLANS. SEE APPENDIX A OF SPECS FOR MORE DETL. OF AG FEATURES. (C - GULLS, BIRDS, DRAGON FLIES)

NOTE: ALL CURVES MUST BE CONTINUOUS SMOOTH & ROUNDED; NO FLATTENING OR SHARP BENDING OF ANY CURVILINEAR LINES. CAD DESIGN MAY MISTAKENLY RENDER SOME THIS WAY, BUT IT MUST NOT BE TRANSFERRED TO THE FLOOR. CONSULT DESIGN PROFESSIONAL FOR ANY QUESTIONABLE LINES PRIOR TO POURING. TZO STRIPS MUST COME TO CLEAN SHARP POINTS USING A MITERED END (NO BUTTENDS). TZO CONTRACTOR TO PULL UP CARPET AROUND BAGGAGE BELTS & PLACE TZO STRIPS 1/2" OUT FROM BASE / TOE KICK OF BELTS.

GENERAL NOTE:
 PROPER SCALE OF THIS COPY AND ACCURACY OF NOTED REFERENCE DIMENSIONS ON DRAWING NEED TO BE VERIFIED IN FIELD BY CONTRACTOR. MINOR VARIANCES DUE TO REPRODUCTION AND PRINTING PROCESS MIGHT OCCUR.

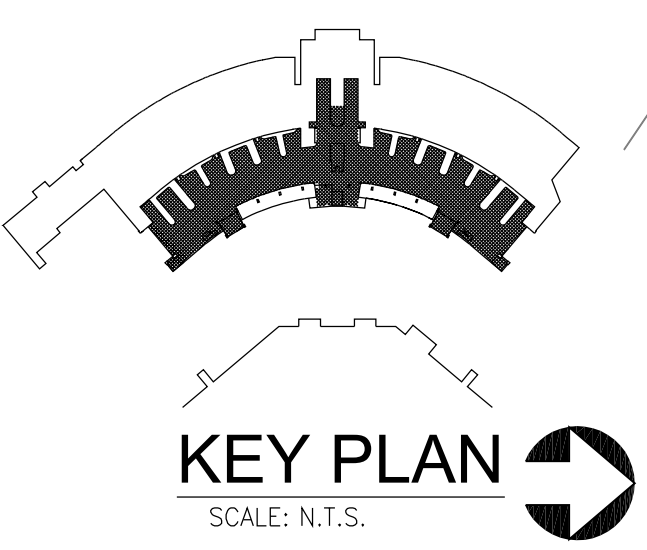

1
 A110
 FLOOR PLAN - OVERALL
BAGGAGE CLAIM LOWER LEVEL
 SCALE: 1/16" = 1'-0"

RS&H
 Architectural, Engineering, Planning
 and Environmental Services
 Reynolds, Smith and Hills, Inc.
 1748 Chestwood Park, Boulevard South
 Jacksonville, Florida 32256
 904-256-2500 FAX 904-256-2501
 www.rsandh.com
 FL Cert Nos. AAC001886 EB0005620 LCC000210

JAX
 Jacksonville
 International
 Airport
JACKSONVILLE
 AVIATION AUTHORITY

JACKSONVILLE
INTERNATIONAL
AIRPORT

INTERIOR DESIGN
FLOOR FINISHES

KTD Inc.
Design
 KELLY TAAFFE DESIGN

Lic# ID 0002289
 FL# 13 0001146
 Kelly@kellytaaffedesign.com
 Tel.: 813.895.5049
 Fax: 813.805.2371

NO.	DESCRIPTION	DATE
1	TZO LEGEND	11/02/11
2	TZO LEGEND T18, T19	12/04/11
3	FEATURES	12/15/11

DATE ISSUED: 9.25.2011
 REVIEWED BY: KT
 DRAWN BY: cAdvice.us - SB
 DESIGNED BY: KTD.INC - KT
 AEP PROJECT NUMBER
 201-7262-009
 © 2006 REYNOLDS, SMITH AND HILLS, INC.
 SHEET TITLE

LEVEL I
BAGGAGE CLAIM
TERRAZZO

SHEET NUMBER
A110

LEVEL-1-CD100.DWG



PLAN LEGEND - FLOOR FINISHES		
#	PATTERN	SPECIFICATIONS
01	T1	TERAZZO T1 JAX BLUE (NOT USED IN LEVEL 1)
02	T2	TERAZZO T16 SUBSTITUTED FOR T2 WHITE
03	T3	TERAZZO COFFEE
04	T4	TERAZZO T4 LAKE PLACID, AQUA
05	T5	TERAZZO T17 SUBSTITUTED FOR T5 COBOLT
06		
07	T7	TERAZZO T7 PERIWINKLE
18		TERAZZO T18: GULL BODIES RESIN: TERROXY STD. WHITE 50% RUST-FREE METAL SHAVINGS 20% BLANCO MEXICANO #1&2 20% MIRROR #1 & 2 10% FW MOP #3
19		TERAZZO T19: GULL SHADOWS RESIN: TERROXY #788-4D INDIGO VELVET 20% DARK BLUE GLASS # FINE & 1 20% DARK GRAY GLASS # FINE & 1 55% RECYCLED PLATE GLASS # 0.1
10		
11		DIVIDE STRIPS 1/2" ZINC - @ DESIGNS
12		DIVIDE STRIPS 1/2" ZINC TO DIVIDE POURS
13	CJ	CONTROL JOINTS
14		RUBBER FLOOR MATS - BY OTHERS
AG1		AGGREGATE 1: SCATTERING, COLOR A = BLUE, COLOR B = GOLD, THIS AG MIX STARTS THICKEST AT THE DIVIDER STRIP AND GRADUALLY GETS LIGHTER WITH DISTANCE. DESIGN ACCENTS INDICATED BY "AG1" ARE MADE BY STRATEGICALLY SCATTERING I.G. AGGREGATE SIZES #1,2,3. DESIGN PROFESSIONAL TO DIRECT AND PHYSICALLY ASSIST WITH BOTH APPLICATIONS.
AG2		AGGREGATE 2: FEATURES, AGENT A - FEATURE, AGENT B - FEATURE, AGENT C - FEATURE, AGENT D - FEATURE, AGENT E - FEATURE, AGENT F - FEATURE, AGENT G - FEATURE, AGENT H - FEATURE, AGENT I - FEATURE, AGENT J - FEATURE, AGENT K - FEATURE, AGENT L - FEATURE, AGENT M - FEATURE, AGENT N - FEATURE, AGENT O - FEATURE, AGENT P - FEATURE, AGENT Q - FEATURE, AGENT R - FEATURE, AGENT S - FEATURE, AGENT T - FEATURE, AGENT U - FEATURE, AGENT V - FEATURE, AGENT W - FEATURE, AGENT X - FEATURE, AGENT Y - FEATURE, AGENT Z - FEATURE. DESIGN ELEMENTS INDICATED "AG2" REPRESENT FIGURES MADE SIMPLY OF STRATEGICALLY PLACED AGGREGATE. THEY INVOLVE NO DIVIDER STRIPS, NO CHANGE IN RESIN COLOR OR T2 FORMULA. THEY ARE DIVIDED SIMPLY BY HANDPLACING I.G. AGGREGATE AT LEAST SIZE #30 IN SHAPES INDICATED ON THE PLANS. SEE APPENDIX A OF SPECS FOR MORE DETL. OF AG FEATURES (e.g., GULLS, DRAGON FLIES).

NOTE: ALL CURVES MUST BE CONTINUOUS SMOOTH & ROUNDED. NO FLATTENING OR SHARP BENDING OF ANY CURVILINEAR LINES. CAD DESIGN MAY MISTAKENLY RENDER A LINE THIS WAY, BUT IT MUST NOT BE TRANSFERRED TO THE FLOOR. CONSULT DESIGN PROFESSIONAL FOR ANY QUESTIONABLE LINES PRIOR TO POURING TZO. STRIPS MUST COME TO CLEAN SHARP POINTS USING A MITERED END (NO BUTTENDS). TZO CONTRACTOR TO PULL UP CARPET AROUND BAGGAGE BELTS & PLACE TZO STRIPS 1/2" OUT FROM BASE / TOE KICK OF BELTS.

RS&H
 Architectural, Engineering, Planning
 and Environmental Services

Reynolds, Smith and Hills, Inc.
 10748 Deerwood Park Boulevard South
 Jacksonville, Florida 32256
 904-256-2500 FAX 904-256-2501
 www.rsandh.com
 FL Cert Nos. AAC001899 EB0005620 LGC000210

JAX
 Jacksonville
 International
 Airport
JACKSONVILLE
 AVIATION AUTHORITY

JACKSONVILLE
INTERNATIONAL
AIRPORT

INTERIOR DESIGN
FLOOR FINISHES

KTD Inc.
Design
 KELLY TAAFFE DESIGN

Lic# ID 0002289
 FL# 13 0001148
 Kelly@kellytaaffedesign.com
 Tel.: 813.695.5049
 Fax: 813.805.2371

REVISIONS		
NO.	DESCRIPTION	DATE
1	TZO LEGEND	11/02/11
2	TZO LEGEND T18, T19	12/04/11
3	FEATURES	12/15/11

DATE ISSUED: 9.25.2011
 REVIEWED BY: KT
 DRAWN BY: cAdvice.us - SB
 DESIGNED BY: KTD, INC - KT

AEP PROJECT NUMBER
 201-7262-009

© 2006 REYNOLDS, SMITH AND HILLS INC.

SHEET TITLE
NORTH WING
LEVEL I
BAGGAGE CLAIM
TERAZZO

SHEET NUMBER
AI.111
 LEVEL-1-CD100.DWG

GENERAL NOTE:
 PROPER SCALE OF THIS COPY AND ACCURACY OF NOTED REFERENCE DIMENSIONS ON DRAWING NEED TO BE VERIFIED IN FIELD BY CONTRACTOR. MINOR VARIANCES DUE TO REPRODUCTION AND PRINTING PROCESS MIGHT OCCUR.

FLOOR PLAN- PARTIAL EAST
BAGGAGE CLAIM NORTH WING
 SCALE: 3/32" = 1'-0"

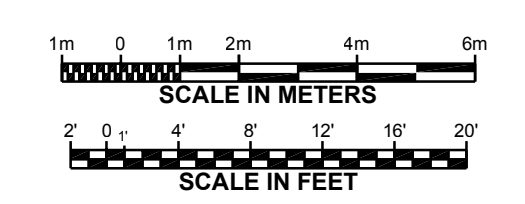
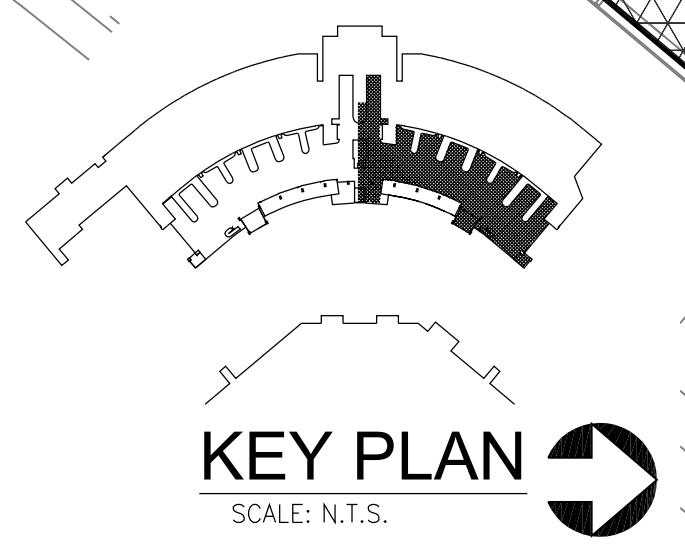

PLAN LEGEND - FLOOR FINISHES

#	PATTERN	SPECIFICATIONS
01	T1	TERAZZO T1 JAY BLUE (NOT USED IN LEVEL 1)
02		TERAZZO T2 SUBSTITUED FOR T1 WHITE
03		T3 TERAZZO COFFEE
04	T4	TERAZZO T4 LAKE PLACID, AQUA
05		TERAZZO T5 SUBSTITUED FOR T5 COBALT
06		
07		TERAZZO T7 PERWINKLE
18		TERAZZO T18: GULL BODIES RESIN: TERROXY STD. WHITE 50% RUST-FREE METAL SHAVINGS 20% BLANCO MEXICANO- #1&2 20% MIRROR- #1&2 10% FW MOP #3 WITH BOTH APPLICATIONS.
19		TERAZZO T19: GULL SHADOWS RESIN: TERROXY #788-4D INDIGO VELVET 25% DARK BLUE GLASS # FINE & 1 20% DARK GRAY GLASS # FINE & 1 50% RECYCLED PLATE GLASS #0.1
10		
11		DIVIDE STRIPS - ZINC - @ DESIGNS
12		DIVIDE STRIPS - ZINC TO DIVIDE POURS
13	CJ	CONTROL JOINTS
14		RUBBER FLOOR MATS - BY OTHERS
AG1		AGGREGATE 1: SCATTERING; COLOR A = BLUE, COLOR B = GOLD, THIS AG MIX STARTS THICKEST AT THE DIVIDER STRIP AND GRADUALLY GETS LIGHTER WITH DISTANCE. DESIGN ACCENTS INDICATED BY "AG1" ARE MADE BY STRATEGICALLY SCATTERED LG. AGGREGATE SIZES #1,2,3. DESIGN PROFESSIONAL TO DIRECT AND PHYSICALLY ASSIST WITH BOTH APPLICATIONS.
AG2		AGGREGATE 2: FEATURES; ACCENT-A---FEATURE---ACCENT-B---FEATURE---SHADOW--- DESIGN ELEMENTS INDICATED "AG2" REPRESENT FIGURES MADE SIMPLY OF STRATEGICALLY PLACED AGGREGATE. THEY INVOLVE NO DIVIDER STRIPS OR CHANGE IN RESIN COLOR OR T2 FORMULA. THEY ARE DIVIDED SIMPLY BY HANDPLACING LG. AGGREGATE (AT LEAST SIZE #2&3) IN SHAPES INDICATED ON THE PLANS. SEE APPENDIX A OF SPECS FOR MORE DETL. OF AG FEATURES (C-GULLS, FISH, DRAGON FLES.

NOTE: ALL CURVES MUST BE CONTINUOUS SMOOTH & ROUNDED. NO FLATTENING OR SHARP BENDING OF ANY CURVILINEAR LINES. CAD DESIGN MAY MISTAKENLY RENDER A LINE THIS WAY, BUT IT MUST NOT BE TRANSFERRED TO THE FLOOR. CONSULT DESIGN PROFESSIONAL FOR ANY QUESTIONABLE LINES PRIOR TO POURING TZO. STRIPS MUST COME TO CLEAN SHARP POINTS USING A MITERED END (NO BUTTENDS). TZO CONTRACTOR TO PULL UP CARPET AROUND BAGGAGE BELTS & PLACE TZO STRIPS 1/2" OUT FROM BASE, 1 TOE KICK OF BELTS.

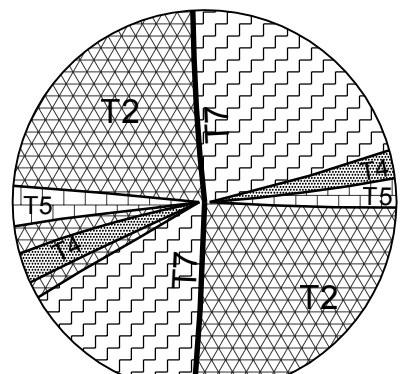

TZO DETAIL NOTE:
3/8" STRIP FRAMING T7 TO CONTINUE THROUGH INTERSECTION OF ALL CONJOINING STRIPS. WHENEVER ONE LINE APPEARS TO CROSS OVER TOP OF OTHER LINES IT (STRIPS) MUST BE CONTINUOUS THROUGH THE INTERSECTION.

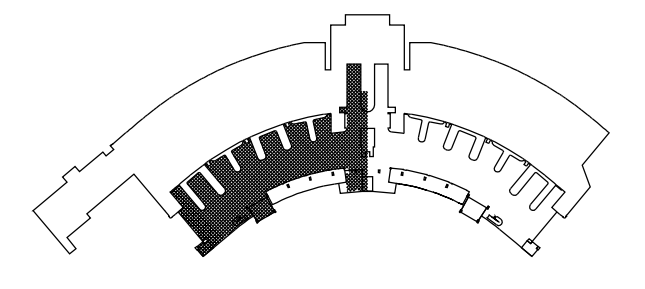

KEY PLAN
SCALE: N.T.S.

1
AI.1.1.2

FLOOR PLAN - PARTIAL WEST
BAGGAGE CLAIM SOUTH WING
SCALE: 3/32" = 1'-0"

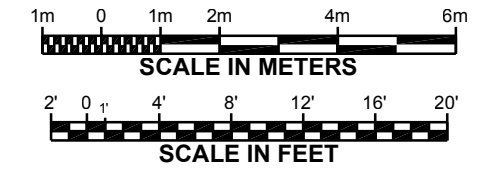

GENERAL NOTE:
PROPER SCALE OF THIS COPY AND ACCURACY OF NOTED REFERENCE DIMENSIONS ON DRAWING NEED TO BE VERIFIED IN FIELD BY CONTRACTOR. MINOR VARIANCES DUE TO REPRODUCTION AND PRINTING PROCESS MIGHT OCCUR.

RS&H
Architectural, Engineering, Planning and Environmental Services
Reynolds, Smith and Hills, Inc.
10748 Deerwood Park Boulevard South
Jacksonville, Florida 32256
904-256-2500 FAX 904-256-2501
www.rsandh.com
FL Cert. Nos. AC001886 EB000520 LG000210

JAX
Jacksonville International Airport
JACKSONVILLE
AVIATION AUTHORITY

JACKSONVILLE
INTERNATIONAL AIRPORT

INTERIOR DESIGN
FLOOR FINISHES

KTD Inc.
Design
KELLY TAAFFE DESIGN

Lic# ID 0002289
FL# 13 0001146
Kelly@kellytaaffedesign.com
Tel: 813.855.5049
Fax: 813.805.2371

REVISIONS

NO.	DESCRIPTION	DATE
1	TZO LEGEND	11/02/11
2	TZO LEGEND T18, T19	12/04/11
3	FEATURES	12/15/11

DATE ISSUED: 9.25.2011
REVIEWED BY: KT
DRAWN BY: cAdvice.us - SB
DESIGNED BY: KTD.INC - KT
AEP PROJECT NUMBER
201-7262-009
© 2006 REYNOLDS, SMITH AND HILLS INC.

SHEET TITLE
SOUTH WING
LEVEL I
BAGGAGE CLAIM
TERAZZO

SHEET NUMBER
AI.112
LEVEL-1-CD100.DWG

BID ALTERNATE

GENERAL NOTE:
 PROPER SCALE OF THIS COPY AND ACCURACY OF NOTED REFERENCE DIMENSIONS ON DRAWING NEED TO BE VERIFIED IN FIELD BY CONTRACTOR. MINOR VARIANCES DUE TO REPRODUCTION AND PRINTING PROCESS MIGHT OCCUR.

NOTE:
 ALL CURVILINEAR DESIGN ELEMENTS TO HAVE SMOOTH TRANSITIONS BETWEEN CURVES TO BE REFLECTED IN 7'-11" SHOP DRAWINGS AND ON SITE LAYOUT. CONTRACTOR REQUIRED TO INTERFACE W/ ALL NEW OR EXISTING WALL BASE MATERIALS (MAJORITY WALL BASE = STAINLESS STEEL), WALL BASE BY OTHERS.
 CONTROL + EXPANSION JOINTS TO ADHERE TO ALL NTMA SPECIFICATIONS FOR EXISTING SLAB. CONTRACTOR TO REFLECT TYPICAL PLACEMENT AND TYPE IN SHOP DRAWINGS SUBMITTAL.
 WALL BASE BY OTHERS UNLESS OTHERWISE NOTED (EX. STRINGERS AT STAIRS INCLUDED IN SOME CASES, SEE DETAILS).
 AGGREGATE FOR SCATTERING AND FEATURES DOES NOT IN ANYWAY INCREASE THE OVERALL AMOUNT OF AGGREGATE NEEDED FOR THE PROJECT. THE CONTRACTOR SHALL CALCULATE BY SUBSTITUTING AGGREGATES FOR SCATTERING AND FEATURES FOR REGULAR MATRIX AGGREGATES.

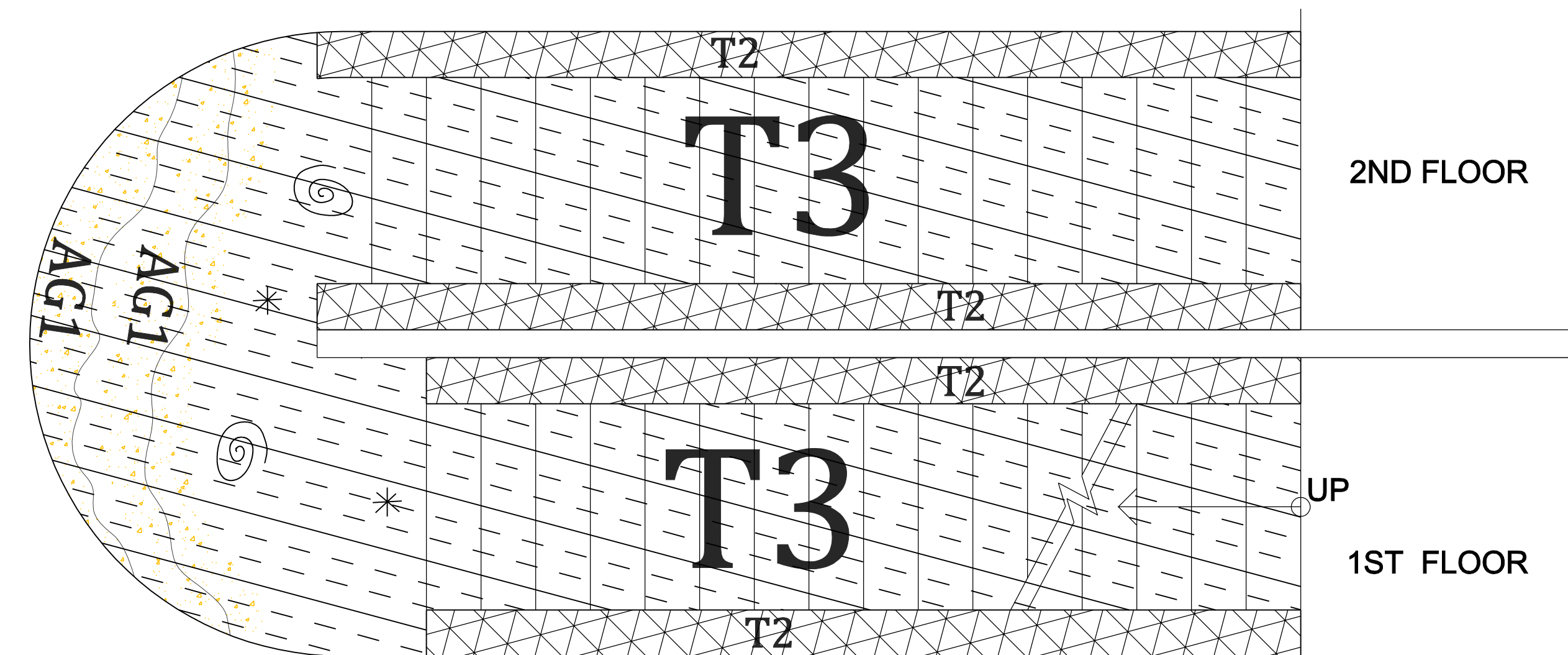

2 FLOOR PLAN - STAIRS
BAGGAGE CLAIM SOUTH STAIR
 SCALE: 1/2" = 1'-0"

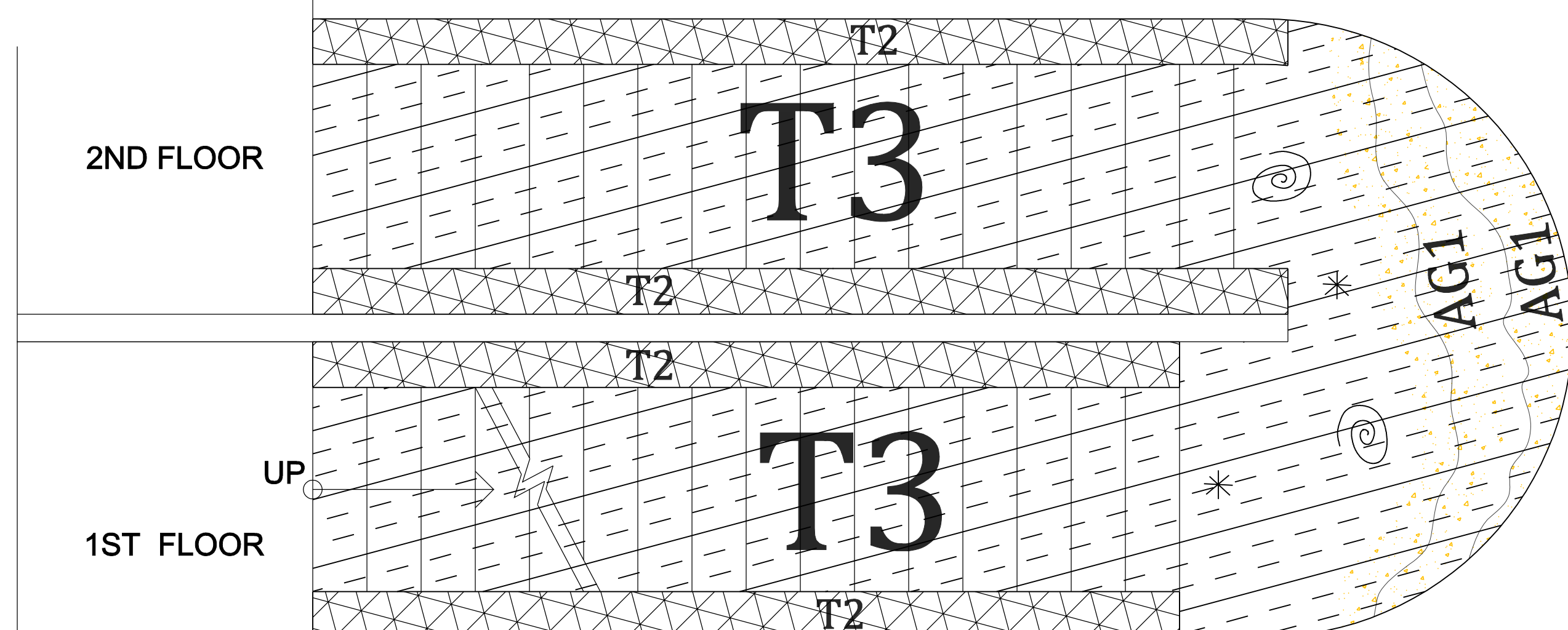

1 FLOOR PLAN - STAIRS
BAGGAGE CLAIM NORTH STAIR
 SCALE: 1/2" = 1'-0"

PLAN LEGEND - FLOOR FINISHES		
#	PATTERN	SPECIFICATIONS
01	T1	TERAZZO T1 JAX BLUE (NOT USED IN LEVEL 1)
02	T2	TERAZZO T2 SUBSTITUED FOR T2 WHITE
03	T3	T3 TERAZZO COFFEE
04	T4	TERAZZO T4 LAKE PLACID, AQUA
05	T5	TERAZZO T5 SUBSTITUED FOR T5 COBALT
06		
07	T7	TERAZZO T7 PERIWINKLE
18	T18	TERAZZO T18: GULL BODIES RESIN: TERROXY STD. WHITE 50% RUST-FREE METAL SHAVINGS 20% BLANCO MEXICANO # 182 20% MIRROR # 1 82 10% PW MOP #3
19	T19	TERAZZO T19: GULL SHADOWS RESIN: TERROXY # 788-40 INDIGO VELVET 20% DARK BLUE GLASS # FINE & 1 20% DARK GRAY GLASS # FINE & 1 55% RECYCLED PLATE GLASS #E1
10		
11		DIVIDE STRIPS - ZINC - @ DESIGNS
12		DIVIDE STRIPS - ZINC TO DIVIDE POURS
13	CJ	CONTROL JOINTS
14		RUBBER FLOOR MATS - BY OTHERS
AG1		AGGREGATE 1: SCATTERING; COLOR A = BLUE, COLOR B = GOLD. THIS AG MIX STARTS THICKEST AT THE DIVIDER STRIP AND GRADUALLY GETS LIGHTER WITH DISTANCE. DESIGN ACCENTS INDICATED BY "AG1" ARE MADE BY STRATEGICALLY SCATTERED LG. AGGREGATE SIZES #1,2,3. DESIGN PROFESSIONAL TO DIRECT AND PHYSICALLY ASSIST WITH BOTH APPLICATIONS.
AG2	AG2	AGGREGATE 2: FEATURE, ACCENT, A - FEATURE, ACCENT, B - FEATURE, SHADOW. DESIGN ELEMENTS INDICATED "AG2" REPRESENT FIGURES MADE SIMPLY OF STRATEGICALLY PLACED AGGREGATE. THEY INVOLVE NO DIVIDERS OR STRIPS OR CHANGE IN RESIN COLOR OR T2 FORMULA. THEY ARE DIVIDED SUPPLY BY HAND PLACING LG. AGGREGATE AT LEAST SIZE #3/32" SHAPES INDICATED ON THE PLANS. SEE APPENDIX A OF SPECS FOR MORE DETL. OF AG FEATURES: CIRCLES, SQUARES, TRIANGLES, DRAGON FLIES.

NOTE: ALL CURVES MUST BE CONTINUOUS SMOOTH & ROUNDED. NO FLATTENING OR SHARP BENDING OF ANY CURVILINEAR LINES. CAD DESIGN MAY MISTAKENLY RENDER A LINE THIS WAY, BUT IT MUST NOT BE TRANSFERRED TO THE FLOOR. CONSULT DESIGN PROFESSIONAL FOR ANY QUESTIONABLE LINES PRIOR TO POURING T20. STRIPS MUST COME TO CLEAN SHARP POINTS USING A MITERED END (NO BUTTENDS). T20 CONTRACTOR TO PULL UP CARPET AROUND BAGGAGE BELTS & PLACE T20 STRIPS 1/2" OUT FROM BASE / TOE KICK OF BELTS.

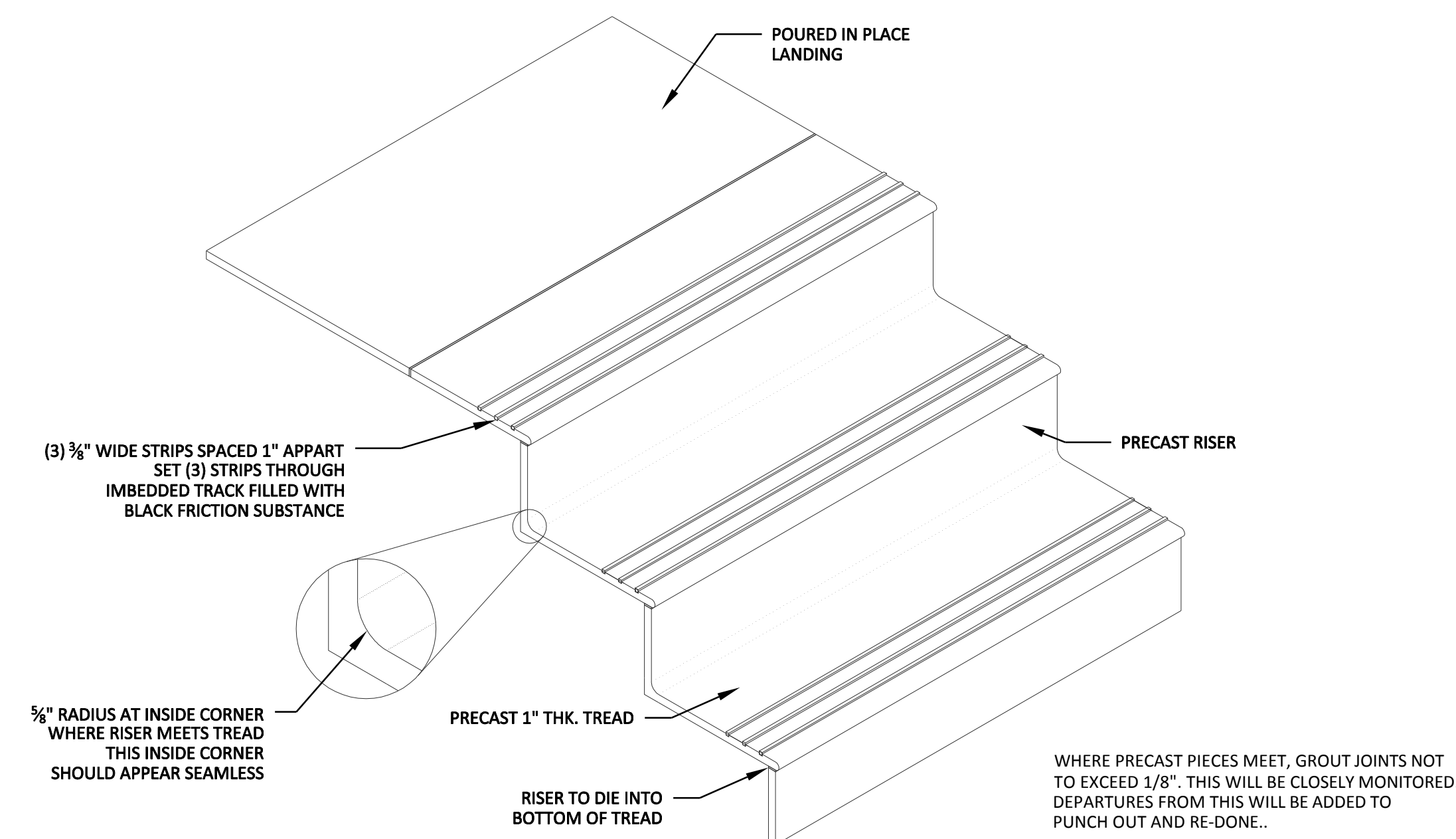

3 STAIR DETAIL
 SCALE: 1/2" = 1'-0"
 " FINISHED STAIR SYSTEMS MUST COMPLY WITH ALL ADA AND SAFETY CODES."



Reynolds, Smith and Hills, Inc.
 1748 Chestwood Park, Balairend South
 Jacksonville, Florida 32256
 904-256-2500 FAX 904-256-2501
 www.rsandh.com
 FL Cert Nos. AAC001886 EB0005620 LOC000210



JACKSONVILLE INTERNATIONAL AIRPORT

INTERIOR DESIGN FLOOR FINISHES



Lic# ID 0002289
 FL# 13 0001146
 Kelly@kellytaaffedesign.com
 Tel.: 813.895.5049
 Fax: 813.895.2371

REVISIONS		
NO.	DESCRIPTION	DATE
1	TZO LEGEND	11/02/11
2	TZO LEGEND T18, T19	12/04/11
3	FEATURES	12/15/11

DATE ISSUED: 9.25.2011
 REVIEWED BY: KT
 DRAWN BY: cAdvice.us - SB
 DESIGNED BY: KTD, INC - KT
 AEP PROJECT NUMBER
 201-7262-009
 © 2006 REYNOLDS, SMITH AND HILLS, INC.

SHEET TITLE
STAIRS LEVEL I BID ALTERNATE TERAZZO

SHEET NUMBER
AI.113
 LEVEL-1-CD100.DWG

GENERAL NOTE:
 PROPER SCALE OF THIS COPY AND ACCURACY OF NOTED REFERENCE DIMENSIONS ON DRAWING NEED TO BE VERIFIED IN FIELD BY CONTRACTOR. MINOR VARIANCES DUE TO REPRODUCTION AND PRINTING PROCESS MIGHT OCCUR.

REVISIONS

NO.	DESCRIPTION	DATE
1	TZO LEGEND	11/02/11
2	TZO LEGEND T18, T19	12/04/11
3	FEATURES	12/15/11

DATE ISSUED: 9.25.2011
 REVIEWED BY: KT
 DRAWN BY: cAdvice.us - SB
 DESIGNED BY: KTD, INC - KT

AEP PROJECT NUMBER
 201-7262-009

© 2006 REYNOLDS, SMITH AND HILLS, INC.

SHEET TITLE
DETAILS
LEVEL I
BAGAGE CLAIM
TERRAZZO

SHEET NUMBER
AI.114

LEVEL-1-CD100.DWG

EPOXY TERRAZZO 1/4" OR 3/8"

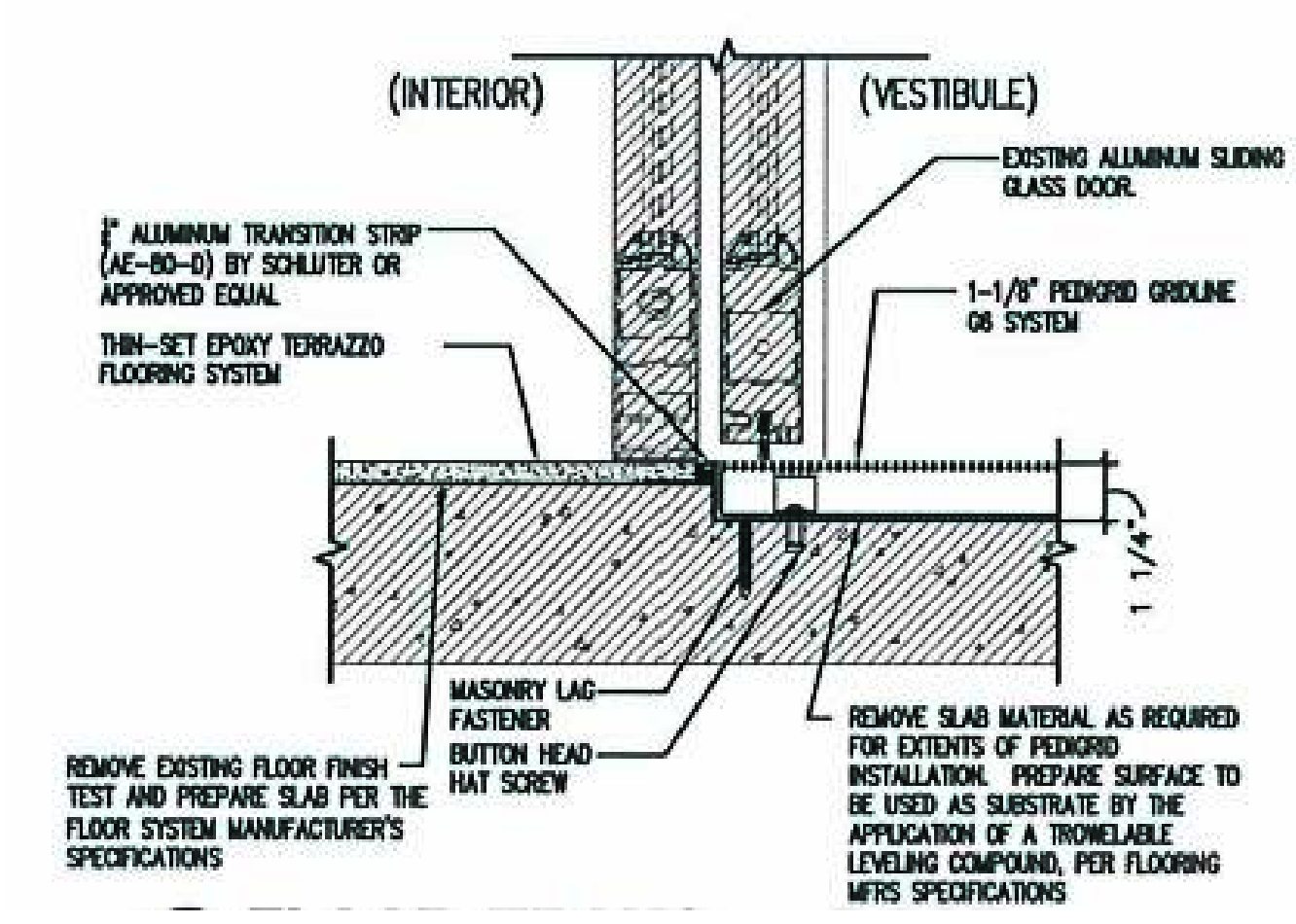

1 FLOOR TRANSITION @ DOOR
 AI.114 SCALE: N/A

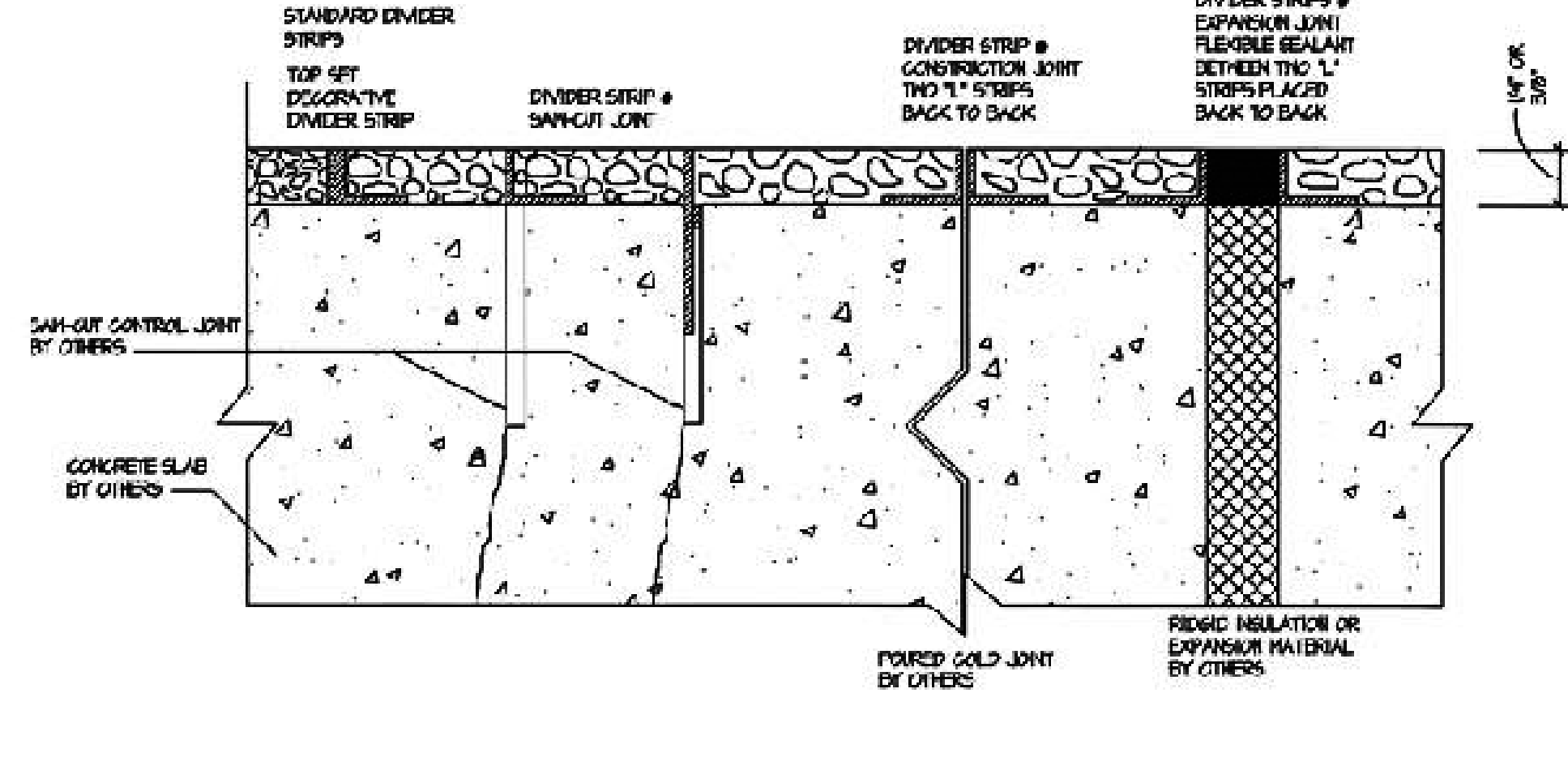

2 STANDARD DIVIDER STRIPS
 AI.114 SCALE: N/A

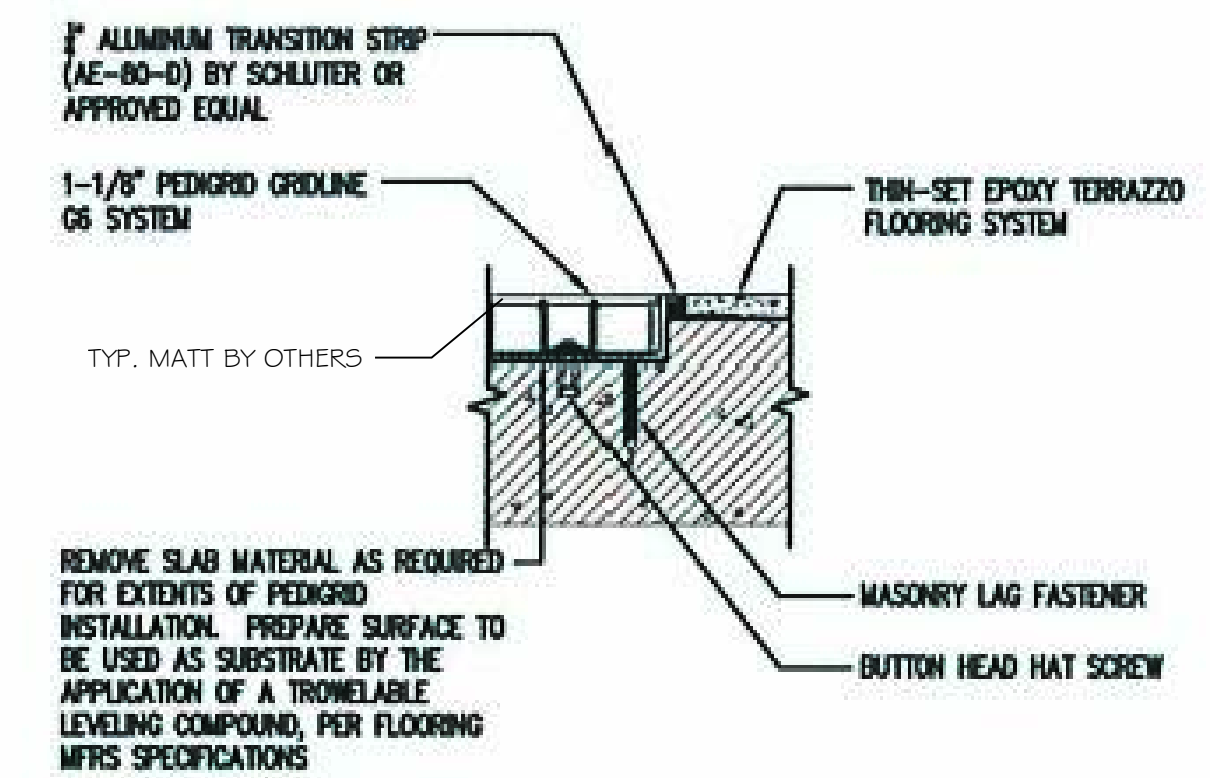

3 W.O.MATT/TERR TRANSITION
 AI.114 SCALE: N/A

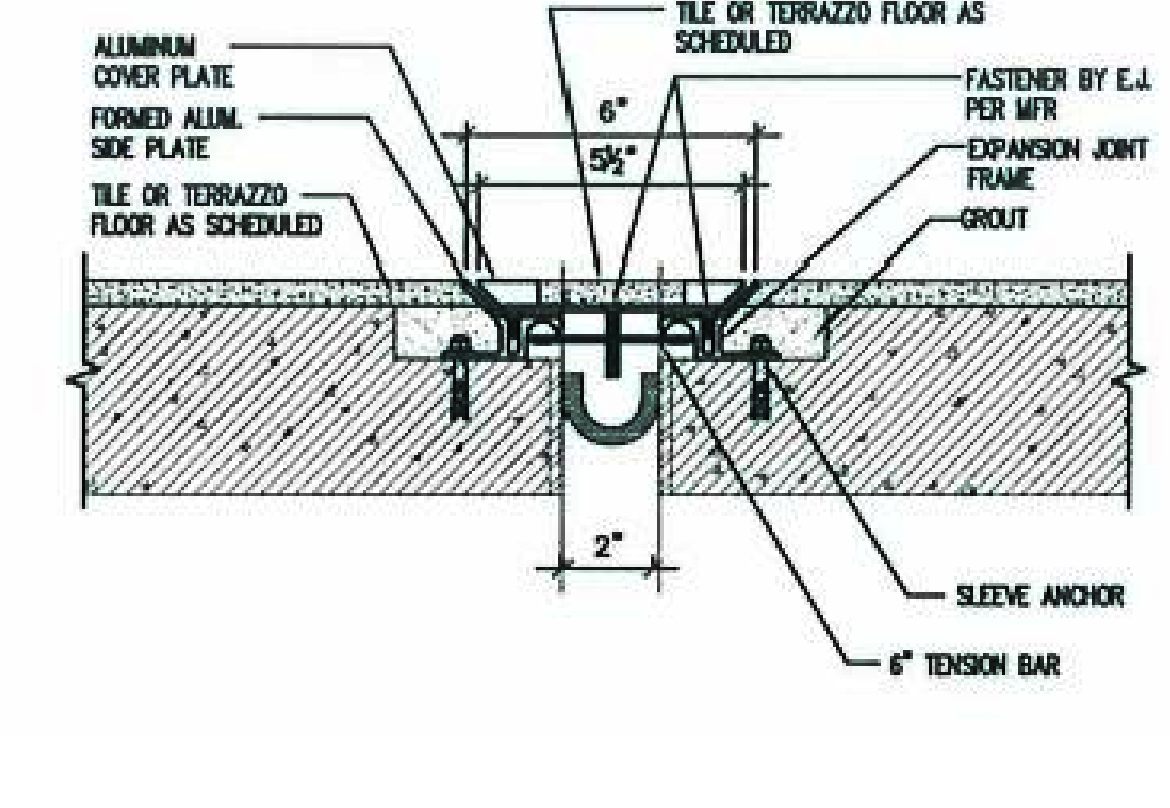

4 EXPANSION JOINT DTL.
 AI.114 SCALE: N/A

Soft-Joint Detail

In situations where saw cuts have not been made in substrate, it is recommended to include a Soft-Joint in terrazzo topping to compensate for any thermal expansion or contraction. Soft-joints have been used successfully on previous projects. There is no guarantee of complete crack prevention in the terrazzo due to a number of uncontrolled site conditions. If you proceed with this Soft-Joint detail, a maximum of 40 feet between joints is required.

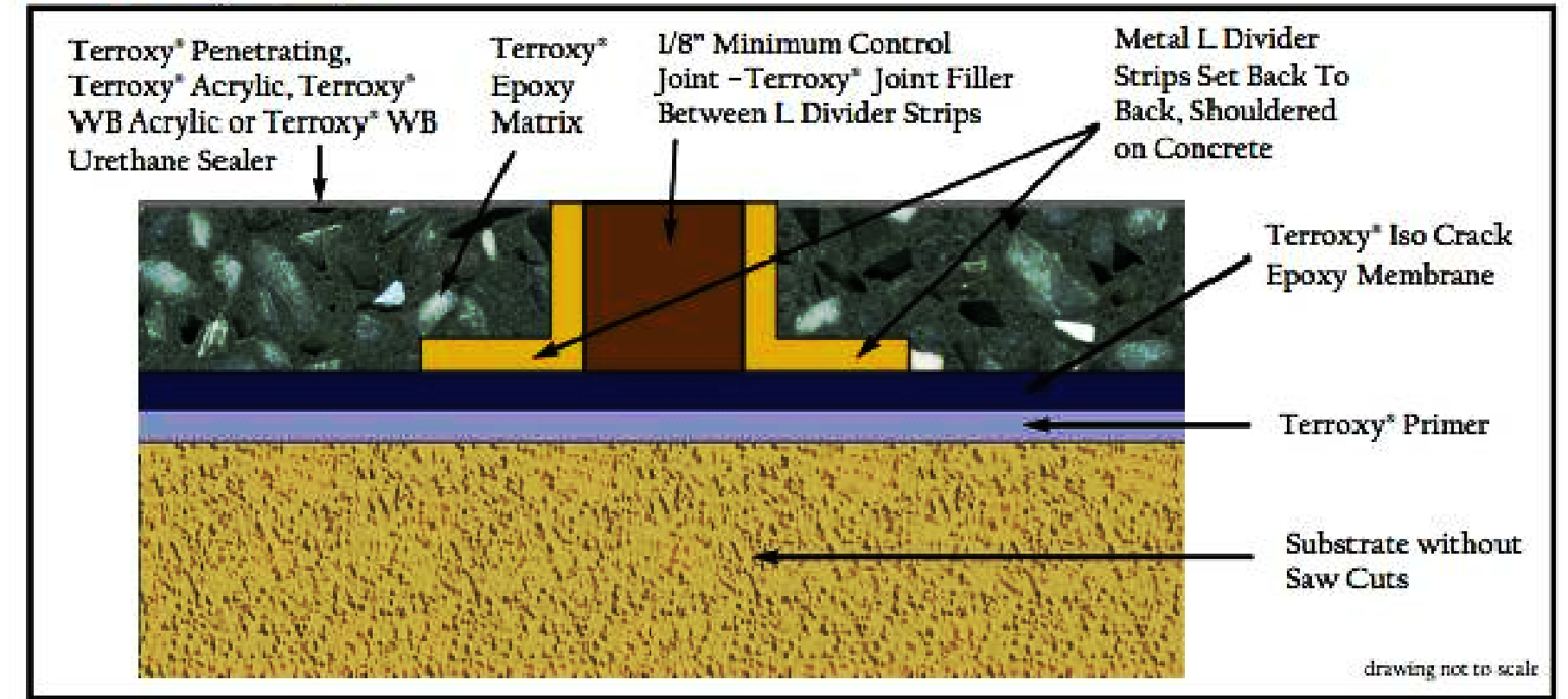

08 SOFT JOINT DETAIL
 AI.114 SCALE: N/A

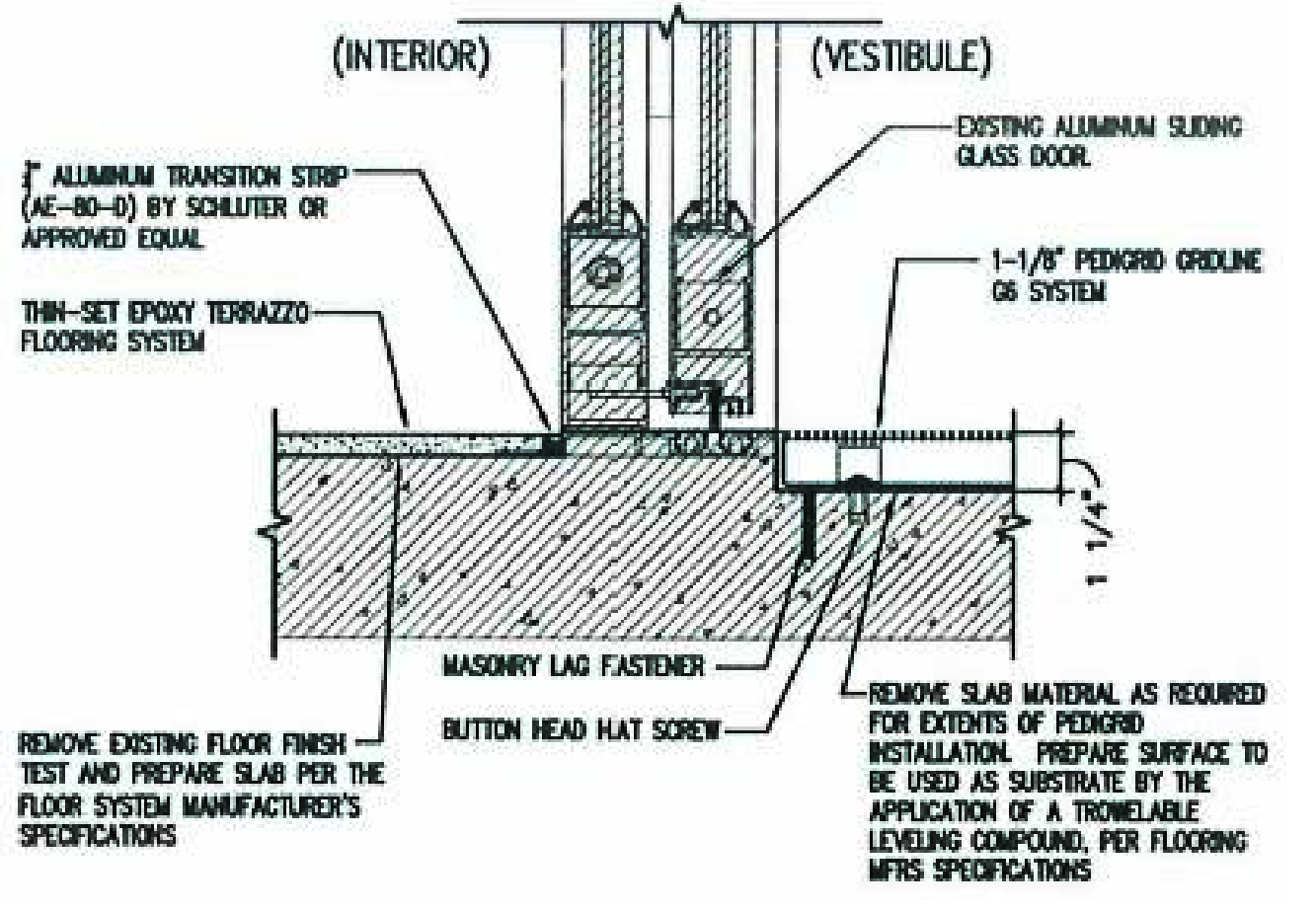

5 INTERIOR DOOR THRESHOLD
 AI.114 SCALE: N/A

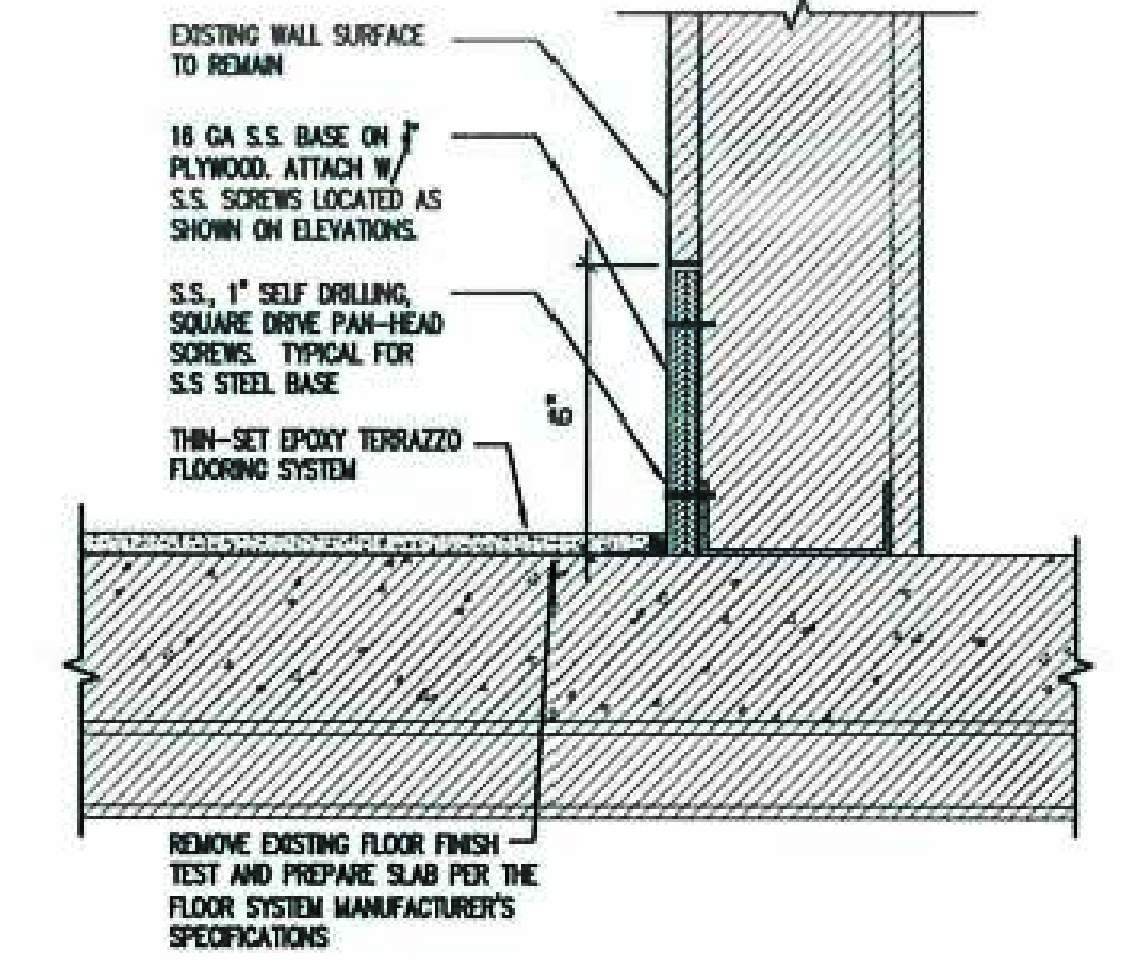

6 STAINLESS STEEL BASE DTL.
 AI.114 SCALE: N/A

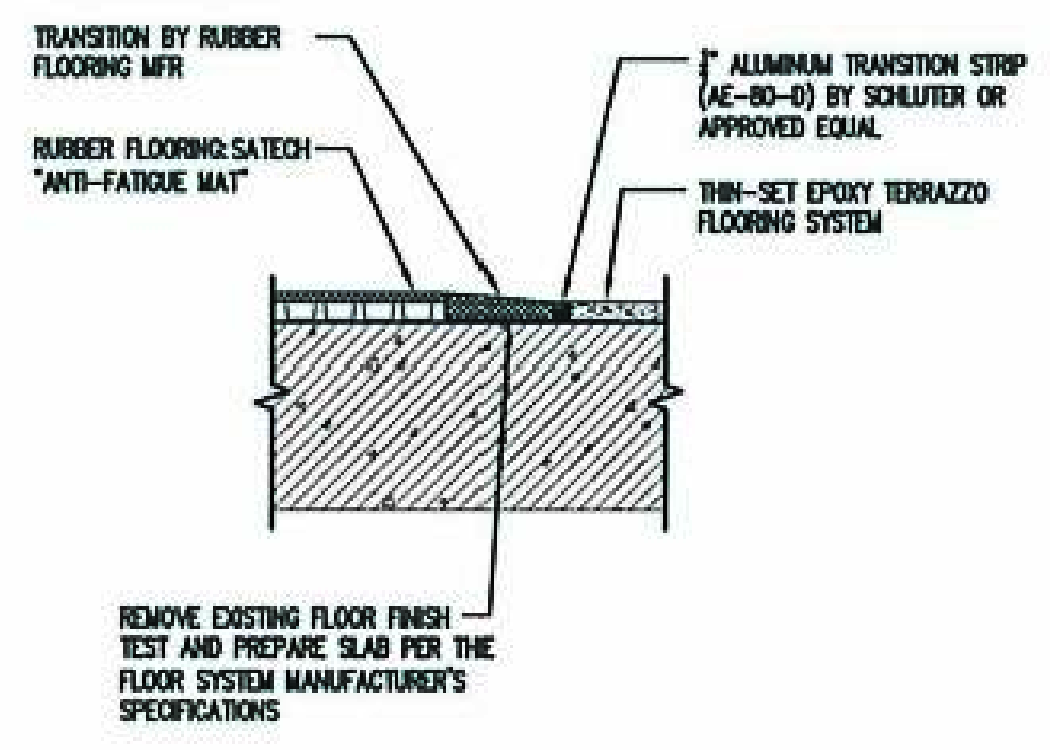

7 TERR / RUBBER FLOOR TRANS
 AI.114 SCALE: N/A



09 EXAMPLES OF AGGREGATE DESIGN FEATURES-DESIGN FEATURES ACHIEVED BY LAYING LARGER AGGREGATE INTO SPECIFIC SHAPES AND IMAGES.
 AI.114



10 EXAMPLE OF AGG SCATTERING-RANDOM VARIATIONS TO AGGREGATE ACHIEVED BY SCATTERING LARGER AGG. AMONG REGULAR MATRIX JUST AFTER IT IS POURED, WHILE IT IS IN LIQUID STATE
 AI.114

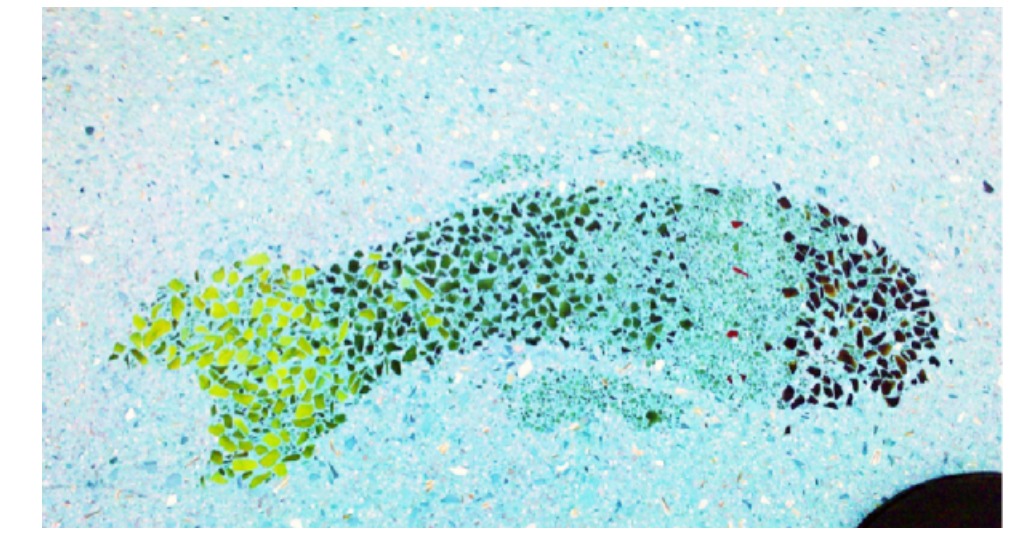

11 AG-2 DESIGN FEATURES
 AI.114 SCALE: N/A

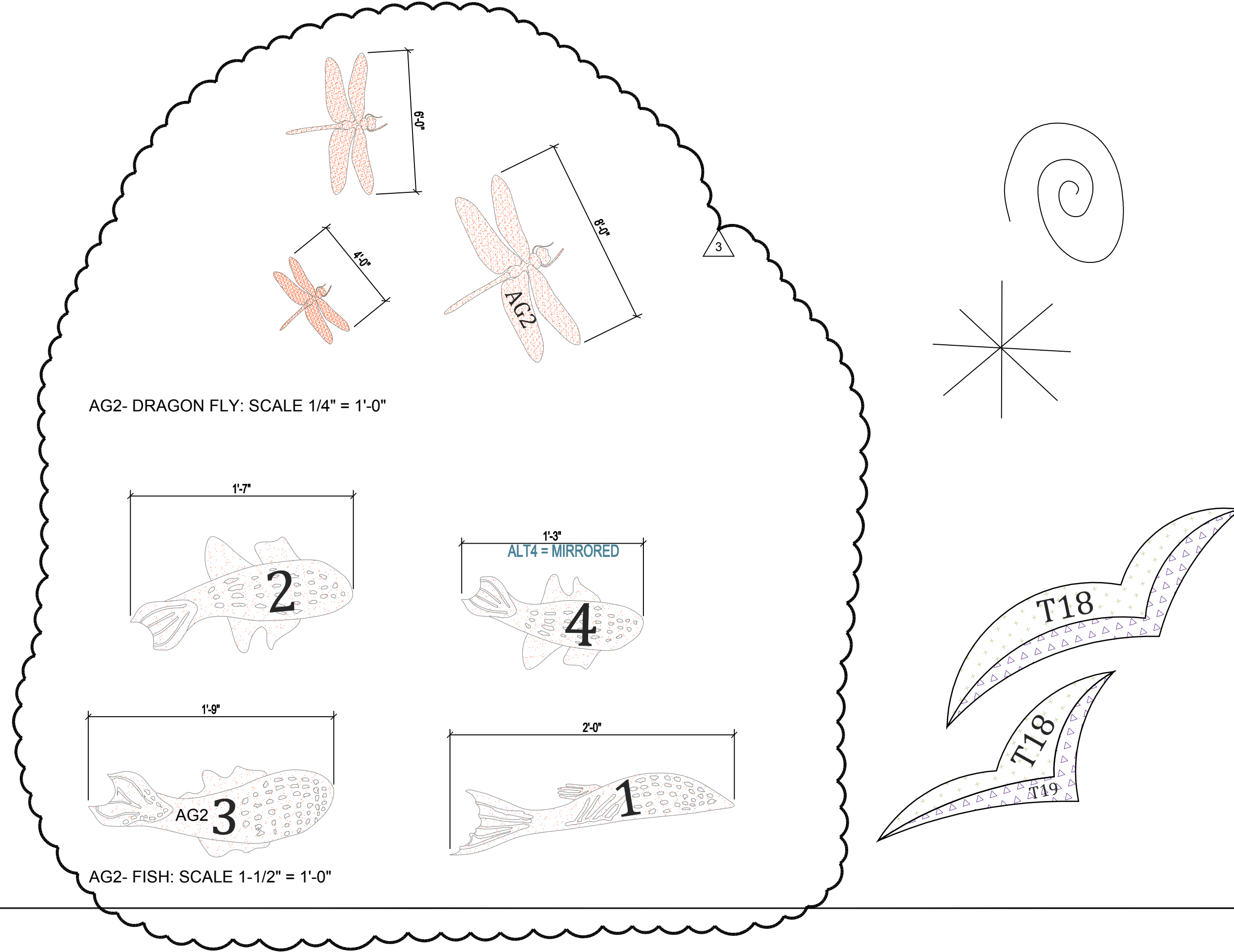

11 AG-2 DESIGN FEATURES
 AI.114 SCALE: N/A

GENERAL NOTE:
 PROPER SCALE OF THIS COPY AND ACCURACY OF NOTED REFERENCE
 DIMENSIONS ON DRAWING NEED TO BE VERIFIED IN FIELD BY CONTRACTOR.
 MINOR VARIANCES DUE TO REPRODUCTION AND PRINTING PROCESS MIGHT
 OCCUR.

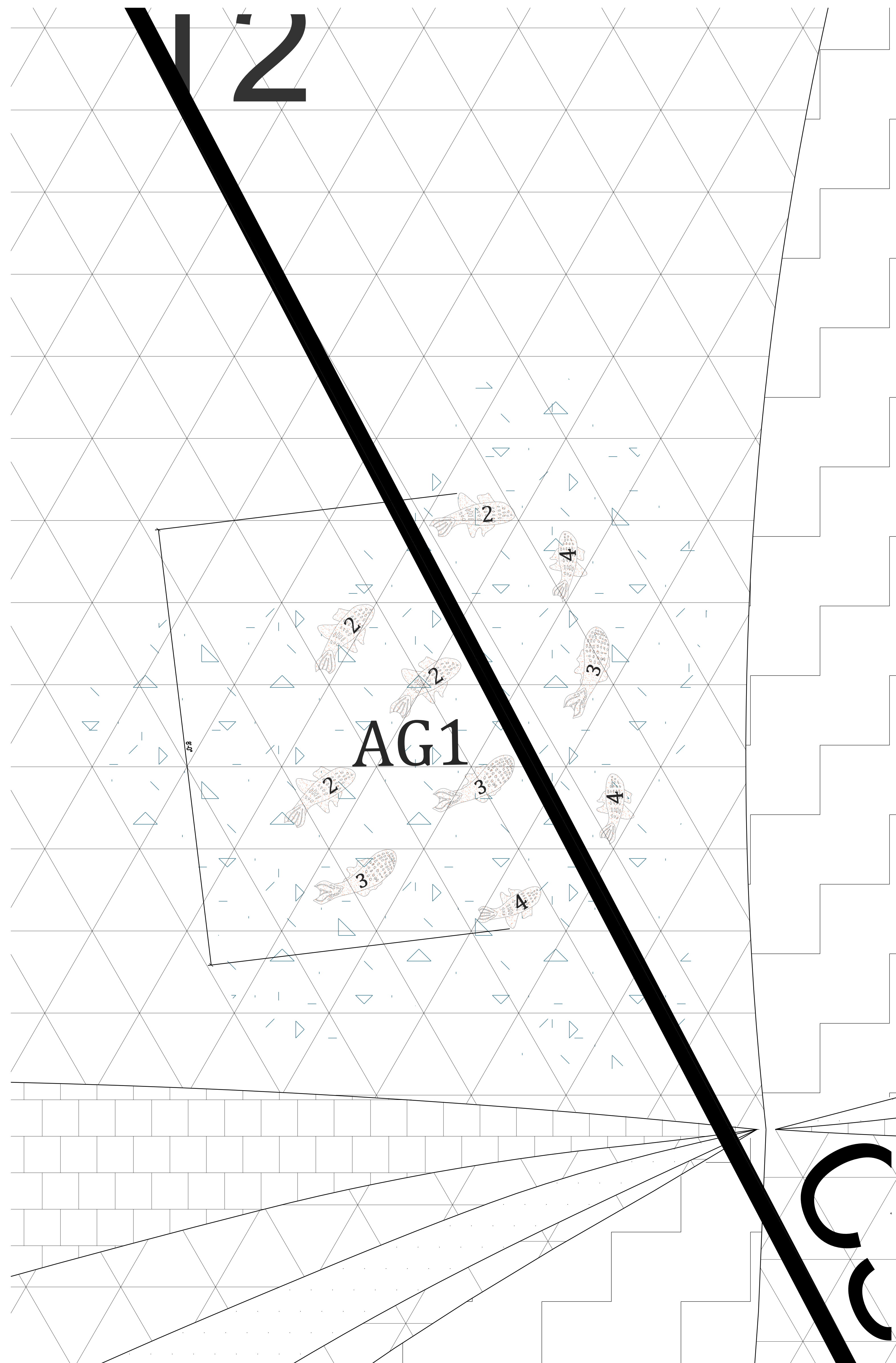

SCHOOL 1, SCHOOL 3 OPPOSITE HAND

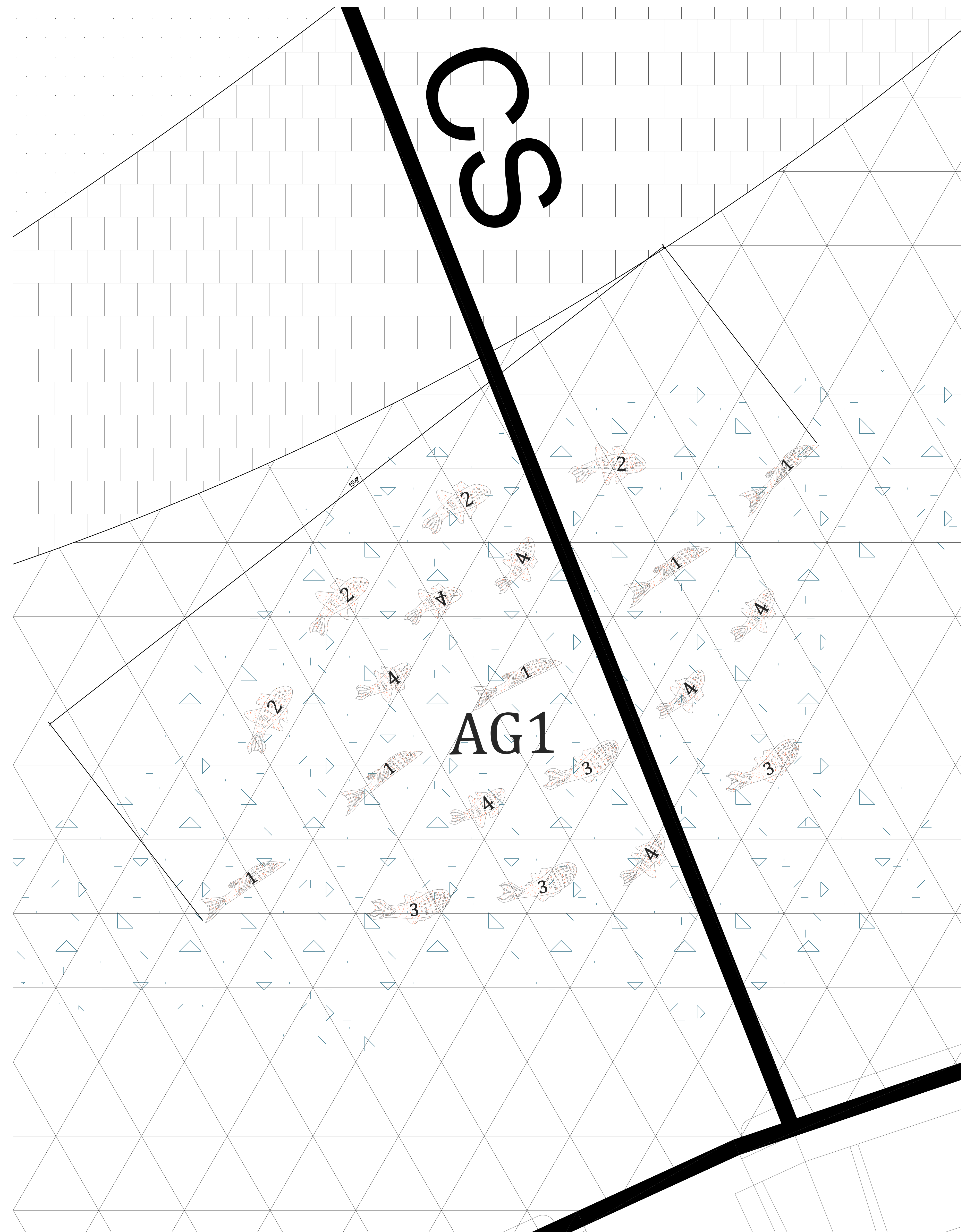

SCHOOL 2, SCHOOL 4 OPPOSITE HAND

01 AG-2 DESIGN FEATURES, AG1-B AGGREGATE SCATTERING
 AI.115 SCALE: 1" = 1'-0"

RS&H
 Architectural, Engineering, Planning
 and Environmental Services
 Reynolds, Smith and Hills, Inc.
 1748 Deerwood Park Boulevard South
 Jacksonville, Florida 32256
 904-256-2500 FAX 904-256-2501
 www.rsandh.com
 FL Cert. Nos. AAC001886 EB0005620 LCC000210

JAX
 Jacksonville
 International
 Airport
JACKSONVILLE
 AVIATION AUTHORITY

JACKSONVILLE
INTERNATIONAL
AIRPORT

INTERIOR DESIGN
FLOOR FINISHES

KTD Inc.
Kelly Taafe
 KELLY TAAFFE DESIGN

Lic# ID 0002289
 FL# 13 0001146
 Kelly@kellytaaffedesign.com
 Tel: 813.805.5049
 Fax: 813.805.2371

REVISIONS

NO.	DESCRIPTION	DATE
1	TZO LEGEND	11/02/11
2	TZO LEGEND T18,T19	12/04/11
3	FEATURES	12/15/11

DATE ISSUED: 9-25-2011
 REVIEWED BY: KT
 DRAWN BY: cAdvice.us - SB
 DESIGNED BY: KTD.INC - KT
 AEP PROJECT NUMBER
 201-7262-009
 © 2006 REYNOLDS, SMITH AND HILLS, INC.

SHEET TITLE
DETAILS
LEVEL I
BAGAGE CLAIM
TERAZZO

SHEET NUMBER
AI.115
 LEVEL-1-CD100.DWG



JAX

Jacksonville
International
Airport

JACKSONVILLE INTERNATIONAL AIRPORT BAGGAGE CLAIM



Reynolds, Smith and Hills, Inc.

Jacksonville, Florida 32256
904-256-2500 FAX 904-256-2501
FL.Cert.Nos. AAC001886 EB0005620 LCC000210

PROJECT

TERRAZZO FLOOR FINISHES
100% CD



Lic# ID 0002289
FL# 13 0001146
Kelly@kellytaaffedesign.com
Tel.: 813.695.5049
Fax: 813.805.2371

DRAWING INDEX

- AI.110 FLOOR PLAN IN CONTRACT WORK AREA 1/16" = 1'-0"
- AI.111 FLOOR PLAN PARTIAL IN CONTRACT AREA 3/32" = 1'-0"
- AI.112 FLOOR PLAN PARTIAL IN CONTRACT AREA 3/32" = 1'-0"
- AI.113 DETAILS DETAILS STAIRS VARIES
- AI.114 DETAILS DETAILS TZO FEATURES VARIES
- AI.115 DETAILS ENLARGED FP 1"= 1'-0"