

**ISSUED FOR PERMITTING**

**REVISIONS**

No.	Description	Date	By

Designed by: \_\_\_\_\_ Drawn by: \_\_\_\_\_ Checked by: \_\_\_\_\_

Project Name:  
**TERMINAL ADDITIONS - PHASE III  
GATES 7-10 TERMINAL  
IMPROVEMENTS**

Drawing Name:  
**Floor Plan-  
Ground Level  
Gate 7-10**

Project Number: #140743 Division: Architecture

Date: JULY 12, 2015

Drawing Number:  
**INT1.01**

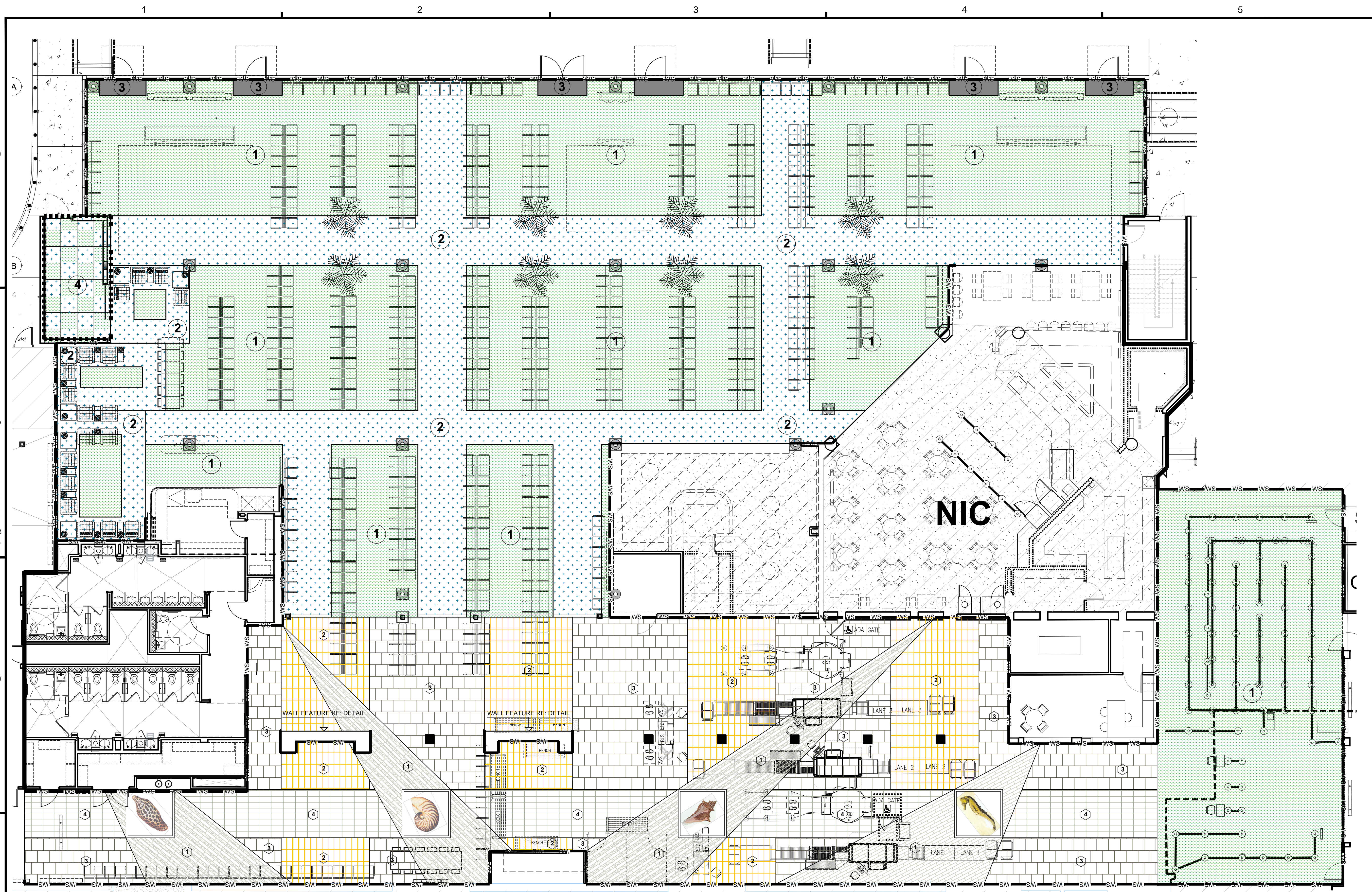

**FLOOR FINISHES LEGEND**

**CARPETS**

- (C1) MAIN PATTERN (WILTON, MATCH EXIST.)
- (C2) TWEED (WILTON, MATCH EXISTING)
- (C3) BLACK WALK OFF
- (C4) KIDS ZONE RUBBER TILE

**FLOOR TILE**

- (T1) CORSICAN CREAEM 6"x24" UNPOLISHED (UP)
- (T1a) CORSICAN CREAEM 6"x24" POLISHED (PO)
- (T2) EMPEROR'S GOLD (UP) 12"x24" VERT. ABUTTING BRICK PATTERN
- (T3) PALAIS TAUPE (UP) 24"x24" OFFSET BRICK PATTERN
- (T4) EMPRESS SILVER 12"x24" HORZ. ABUTTING BRICK PATTERN

**WALL FINISH**

- WS T-5: WAINSCOT TILE BASE @ CROSSVILLE LAMINAM; 1 NATURALI/CREMA MARFIL, 3.0 W/ SCHLUETER CAP #80, UNDER WINDOWS CUT TO FIT.
- F-1: FOAM PANELS INSTALLED ON WALL AS WAINSCOT IN KIDSZONE. \_\_\_\_\_ HGT.



**GATES 7-10 AREA  
FLOOR PLAN-FINISHES**  
SCALE: 1/8" = 1'-0"

Plotted by: Sign on 7/16/2015 9:14:02 PM

INT\_1.01\_Ground Level Gates 7-10 Plan.dwg