

REFERENCE SHEETS 1.1.01/1.02/1.04/1.05/1.07/1.4.01/1.6.02/  
A.1.11/A.1.15 FOR WALL COVER AND PAINT ONLY.

**LEGEND - WALL FINISHES**

- ||||| WC 01 : (MAIN TERMINALS) 54" VINYL NO REPEAT SEE SPECIFICATIONS (BOOK) FOR DETAILS.
  - ||||| WC 01 : (MAIN TERMINALS) IN GATES 2-6 AND TICKETING B AREAS NEW CONSTRUCTION
  - ||||| WC 02 : (GATES 2-6) 54" VINYL NO REPEAT SEE SPECIFICATIONS (BOOK) FOR DETAILS.
  - ||||| WC 03 : (LEVEL II RESTAURANT) FULL HGT. WALL @ 8'-0" 54" VINYL NO REPEAT SEE SPECIFICATIONS (BOOK) FOR DETAILS.
  - ||||| WC 03 : (LEVEL II RESTAURANT) HALF WALL SAME SPEC
  - ||||| WC 04 : (GAGGAGE CLAIM) 54" VINYL NO REPEAT SEE SPECIFICATIONS (BOOK) FOR DETAILS.
  - ||||| WC 05 : (LEVEL II RESTAURANT) 54" VINYL, SEE SPECIFICATIONS (BOOK) FOR DETAILS.
  - ||||| WALL TILE BY OTHERS
  - ||||| T6: TILE WANSCOTT BY TILE CONTRACTOR, SUBSTRATE PROVIDED BY GC FOR "ECONOMIC STIMULUS PROJECT"
  - ||||| T7: TILE WANSCOTT ON KNEEWALL (4'-30" HGT. FIELD VERIFY) + SILL BY TILE CONTRACTOR, SUBSTRATE PROVIDED BY GC FOR "ECONOMIC STIMULUS PROJECT"
- SEE SHEET # 1.6.02 FINISH SCHEDULE FOR PAINT TYPES AND LOCATION

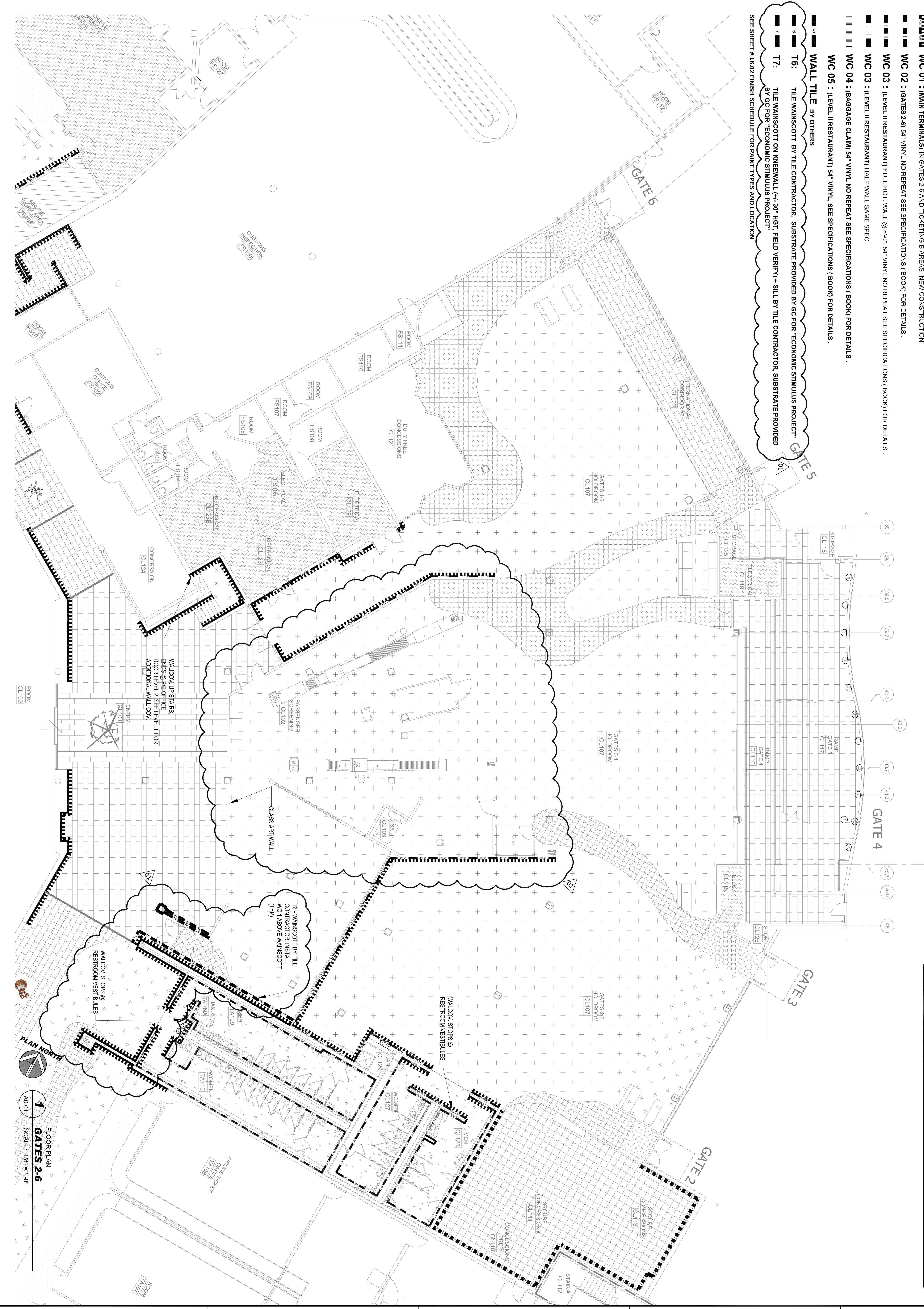

**GENERAL NOTE:**

CONTRACTOR TO REMOVE ANY EXISTING WALL COVER, REPAIR AND PREP WALLS AND REINSTALL NEW WALL COVER IN AREAS AS NOTED ON SCHEDULES AND DRAWINGS.

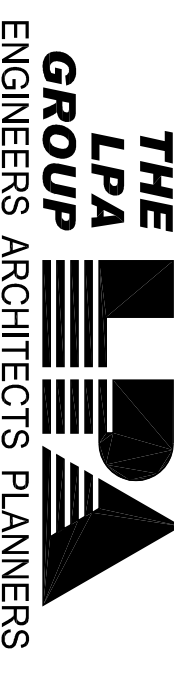

THE LPA GROUP  
ENGINEERS ARCHITECTS PLANNERS  
COLUMBIA, SOUTH CAROLINA 29201  
COLUMBIA, SOUTH CAROLINA 29205-0885  
Phone: 803.252-2211 Fax: 803.779-0482  
14000 WOODBRIDGE FARMWAY, COLUMBIA, SOUTH CAROLINA 29204

Kelly Taaffe Design  
KTD INC  
Llic# ID 002289  
Fl# 13 001148  
Kelly@kellytaaffedesign.com  
Tel.: 813.695.5049  
Fax: 813.805.2371

**TERMINAL IMPROVEMENT PROJECT - WALL FINISHES**

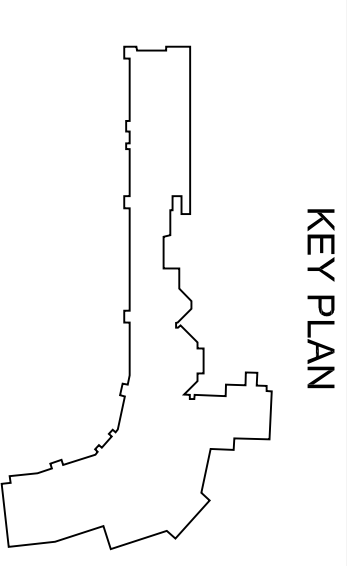

**REVISIONS**

No.	Description	Date	By
01	ADDENDUM 1	04/20/09	KTD

**TERMINAL IMPROVEMENT PROJECT WALL COVER & PAINT**

**FLOOR PLAN GATES 2-6**

Project Name: TERMINAL IMPROVEMENT PROJECT WALL COVER & PAINT  
Drawing Number: 1.1.02  
Date: 04/20/2009  
Scale: 1/8" = 1'-0"  
Drawing Number: 1.1.02