

RS&H

10748 Deerwood Park Blvd South
Jacksonville, Florida 32256
904-256-2500 FAX 904-256-2502
www.rsandh.com
FL Lic# AKC001896 • ESD0006620 • LCC000210

TALLAHASSEE
REGIONAL AIRPORT
TALLAHASSEE, FLORIDA

TALLAHASSEE
REGIONAL AIRPORT
TALLAHASSEE, FLORIDA



KTD Inc.
Design
KELLY TAAFFE DESIGN

Lic# ID 0002289
FL# 13 0001146
Kelly@kellytaaffedesign.com
Tel.: 813.695.5049
Fax: 813.805.2371

IN-LINE
BAGGAGE
HANDLING
SYSTEM

REVISIONS		
NO.	DESCRIPTION	DATE

DATE ISSUED: JULY 23, 2013
REVIEWED BY:
DRAWN BY:
DESIGNED BY:

AEP PROJECT NUMBER
201-2494-000

© 2012 REYNOLDS, SMITH AND HILLS INC.

SHEET TITLE
**OVERALL
SECOND FLOOR
TZO LAYOUT
FLOOR FINISHES**

SHEET NUMBER

INT-120

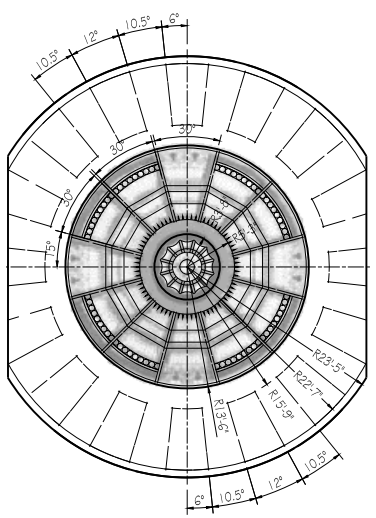

2 ENLARGED INSERT
A120 SCALE: 3/32" = 1'-0"



3 ENLARGED INSERT
A120 SCALE: 3/32" = 1'-0"

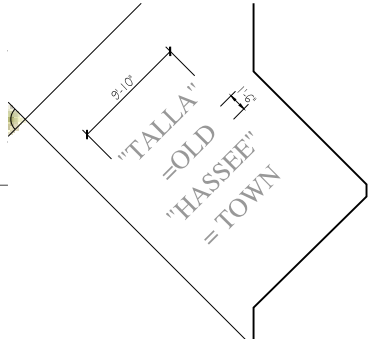

5 OLD TOWN
A120 SCALE: 1/8" = 1'-0"

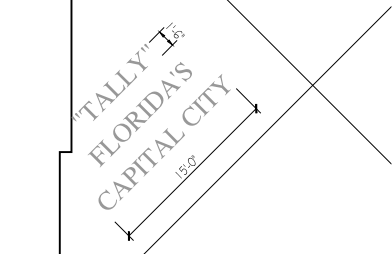

6 CAPITAL CITY
A120 SCALE: 1/8" = 1'-0"



4 ENLARGED INSERT
A120 SCALE: 3/16" = 1'-0"



1 OVERALL SECOND FLOOR PLAN
A120 SCALE: 1" = 20'-0"

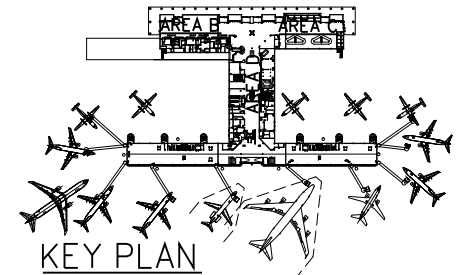

KEY PLAN

NOT FOR CONSTRUCTION

"TALLY" FLORIDA'S CAPITAL CITY

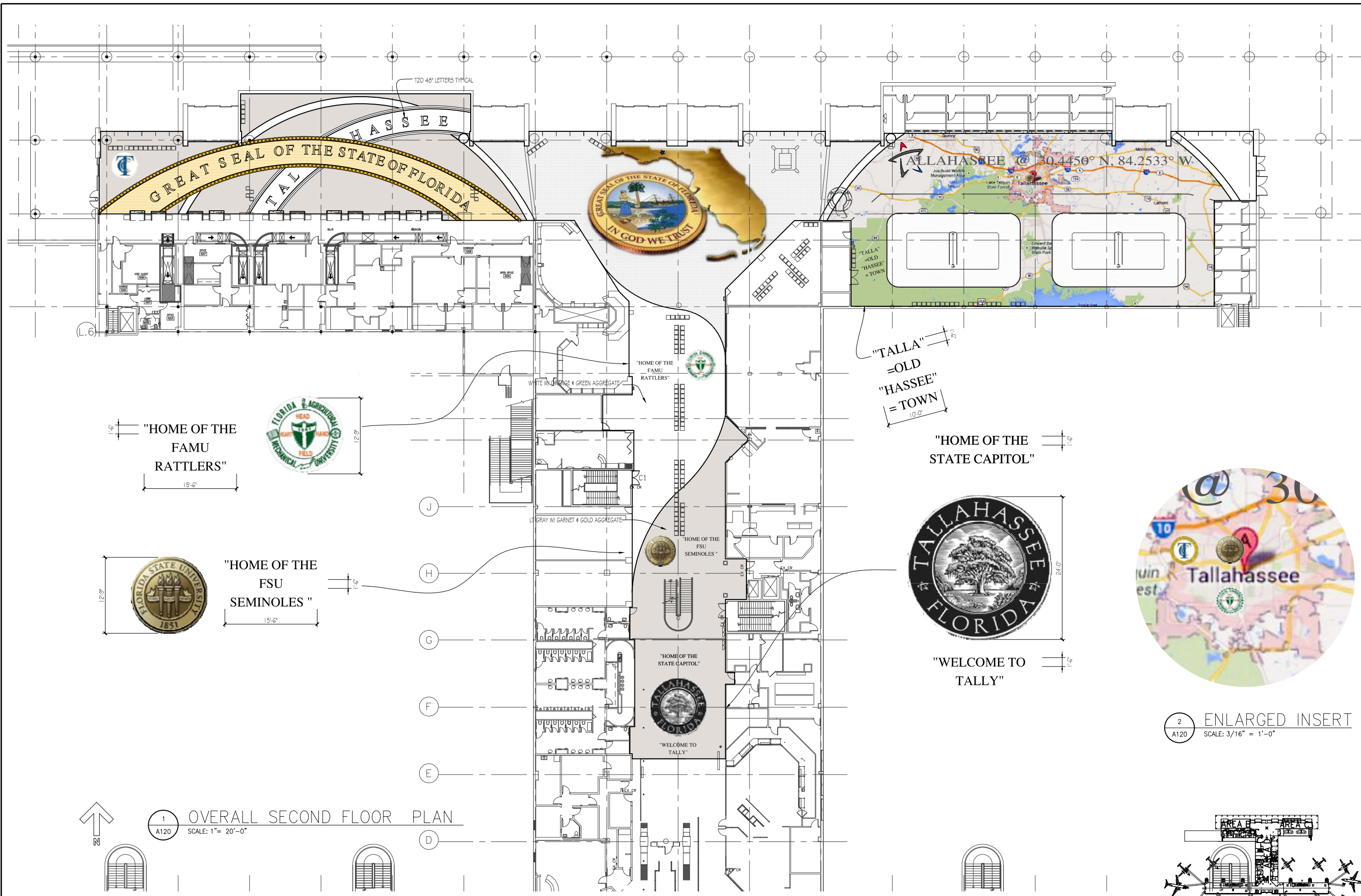

1 OVERALL SECOND FLOOR PLAN
A120 SCALE: 1" = 20'-0"

2 ENLARGED INSERT
A120 SCALE: 3/16" = 1'-0"

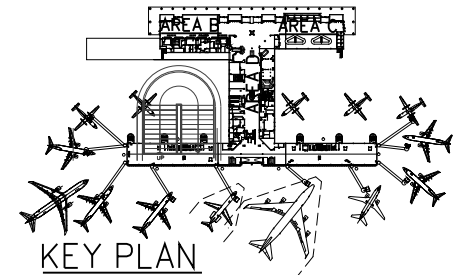
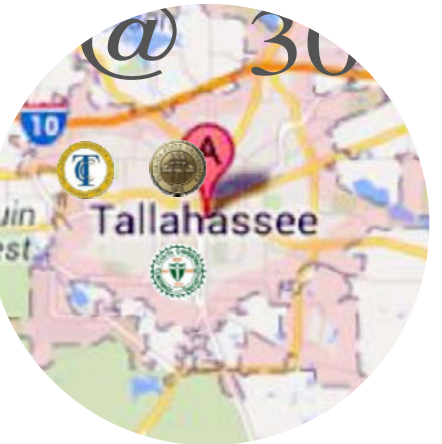

NOT FOR CONSTRUCTION



10748 Deerwood Park Blvd South
Jacksonville, Florida 32256
904-256-2500 FAX 904-256-2502
www.rsandh.com
FL Lic# AKC001896 • ES0006620 • LC0000210



TALLAHASSEE REGIONAL AIRPORT
TALLAHASSEE, FLORIDA



Lic# ID 0002289
FL# 13 0001146
Kelly@kellytaaffedesign.com
Tel: 813.695.5049
Fax: 813.805.2371

IN-LINE BAGGAGE HANDLING SYSTEM

REVISIONS		
NO.	DESCRIPTION	DATE

DATE ISSUED: JULY 23, 2013

REVIEWED BY:

DRAWN BY:

DESIGNED BY:

AEP PROJECT NUMBER
201-2494-000

© 2012 REYNOLDS, SMITH AND HILLS INC.

SHEET TITLE
OVERALL SECOND FLOOR TZO- LAYOUT FLOOR FINISHES

SHEET NUMBER

INT-120

CONCEPT 2

"TALLY" FLORIDA'S CAPITAL CITY



02 AREA D CAMERA PERSPECTIVE
A120 SCALE: NTS



1 AREA B CAMERA PERSPECTIVE
A120 SCALE: NTS

"TALLY" FLORIDA'S CAPITAL CITY

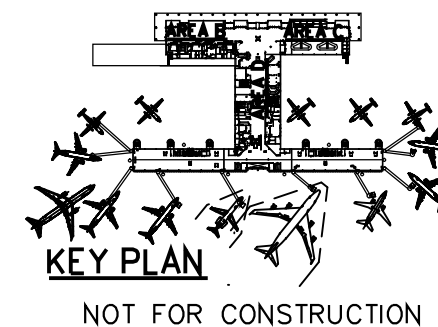

RS&H

10748 Deerwood Park Blvd South
Jacksonville, Florida 32256
904-256-2500 FAX 904-256-2502
www.rsandh.com
FL Lic# MC001888 • EB0005620 • LC0000210

TALLAHASSEE
REGIONAL AIRPORT

TALLAHASSEE, FLORIDA

TALLAHASSEE
REGIONAL AIRPORT

TALLAHASSEE, FLORIDA



KTD, Inc.

Design

KELLY TAAFFE DESIGN

Lic# ID 0002289
FL# 13 0001146
Kelly@kellytaaffedesign.com
Tel.: 813.695.5049
Fax: 813.805.2371

IN-LINE BAGGAGE HANDLING SYSTEM

REVISIONS

NO.	DESCRIPTION	DATE

DATE ISSUED: JULY 23, 2013

REVIEWED BY:

DRAWN BY:

DESIGNED BY:

AEP PROJECT NUMBER
201-2494-000

© 2012 REYNOLDS, SMITH AND HILLS INC.

SHEET TITLE

SECOND FLOOR PLAN AREA D FLOOR FINISHES

SHEET NUMBER

INT-00

CONCEPT 2